

Product list

Please note

his product list includes all parts necessary for most applications.
For parts required for special applications, please refer to the MEVA price list. Dimensions are in centimetres (cm) unless a different unit is shown.

Contents

Adhesive tape, red.....	89	Plastic tube D32.....	98
Alignment rail.....	92	Plug.....	98
Articulated flange nut.....	98	Plug D20.....	92
AS assembly lock.....	90	RS-assembly lock.....	90
AS crane hook.....	99	Safety cage.....	107
AS hinged inside corner.....	88	Safety mesh.....	104
AS hinged outside corner.....	88	Scaffold tube.....	105
AS/ST aluminium filler.....	85	Side railing.....	103
AS/ST outside corner.....	87	Side railing BKB 125.....	109
AS/ST timber profile.....	86	Spacer.....	93
Brace frame 250.....	100	Spanner.....	99
Collapsible clip 4.5.....	101	Stacking angle 60/40/23.....	105
Concrete glue A + B.....	97	StarTec inside corner.....	86
Cone for plastic tube.....	98	StarTec stripping corner.....	89
Cotter pin 4.....	101	StarTec XT panels.....	82
Divinol Wax.....	96	Stop end bracket.....	91
Double-jointed foot plate.....	100	Stripping corner tool.....	89
Extension ladder.....	107	Support angle for walkway brackets.....	93
FB-Aktivstop XT 20 SET.....	96	Swivel-joint coupler 48/48.....	105
Flange screw.....	91	Tensioner AS/ST for foundation tape.....	85
Folding access platform BKB 125.....	109	Tie rod DW.....	98
Folding access platform BKB 125/140.....	109	Tie rod fixture.....	93
Formwork-prop connector.....	100	Tie wrench DW20/DW23.....	99
Foundation tape.....	84	Tilting bracket 40/60.....	103
Guardrailing post.....	102	Trolley for foundation tape.....	85
Guardrailing post 48.....	102	Uni-assembly lock.....	90
Head bolt 16/90.....	101	Uni-tie claw.....	99
Ladder.....	106	Universal shoe MFS.....	104
Ladder connector.....	107	Walkway bracket.....	101
Ladder fixture, lower wall formwork.....	108	XT combi-lever.....	97
Ladder fixture, upper wall formwork.....	108	XT cone DW 20.....	94
Lifting hook 40.....	106	XT fibre concrete plug 47 x 8,5.....	97
M-cross stiffener 44.....	91	XT plug D46.....	97
MEVA Multi-Stopp 23.....	96	XT sealing cone.....	97
Panel height 135 cm.....	84	XT taper tie 23/.....	95
Panel height 270 cm.....	83	XT-Taper Tie Ratchet Spanner SW 17 & SW 19.....	96
Panel height 330 cm.....	82	XT tie rod DW 20.....	94
Plastic tube.....	94		

Wall formwork

StarTec XT panels

Galvanized and post-treated. Frame profile height 12 cm, frame profile depth 60 mm. The frames of the StarTec XT panels consist of closed, torsionally rigid steel profiles. All-around grooves guarantee a stepless, tight and perfectly aligned panel connection using AS assembly locks. The permanently installed, internal and recessed XT tie holes with rotating body enable both single-sided as well as conventional, two-sided tying. All cross stiffeners are equipped with DW threaded nuts and serve as multi-function profiles, allowing easy, fast and safe attachment of accessories. The StarTec XT panels are equipped with alkus facing.

Panel height 330 cm

Nine cross stiffeners with welded-in DW threaded nuts serve as multi-function profiles. Three internal combination tie holes with rotating body for each panel height.

Attention

Unused tie holes must always be closed with plug D35/38.

Ref.-No.	Description / Application	m ²	kg
21-201-01	StarTec XT AL 20 330/270	8.91	540.00
21-201-06	StarTec XT AL 20 330/135	4.46	303.00
21-201-11	StarTec XT AL 17 330/90	2.97	172.00
21-201-41	StarTec XT AL 17 330/60	1.98	114.50
21-201-53	StarTec XT AL 17 330/49	1.62	102.50
21-201-56	StarTec XT AL 17 330/45	1.49	98.30
21-201-71	StarTec XT AL 17 330/30	0.99	77.00

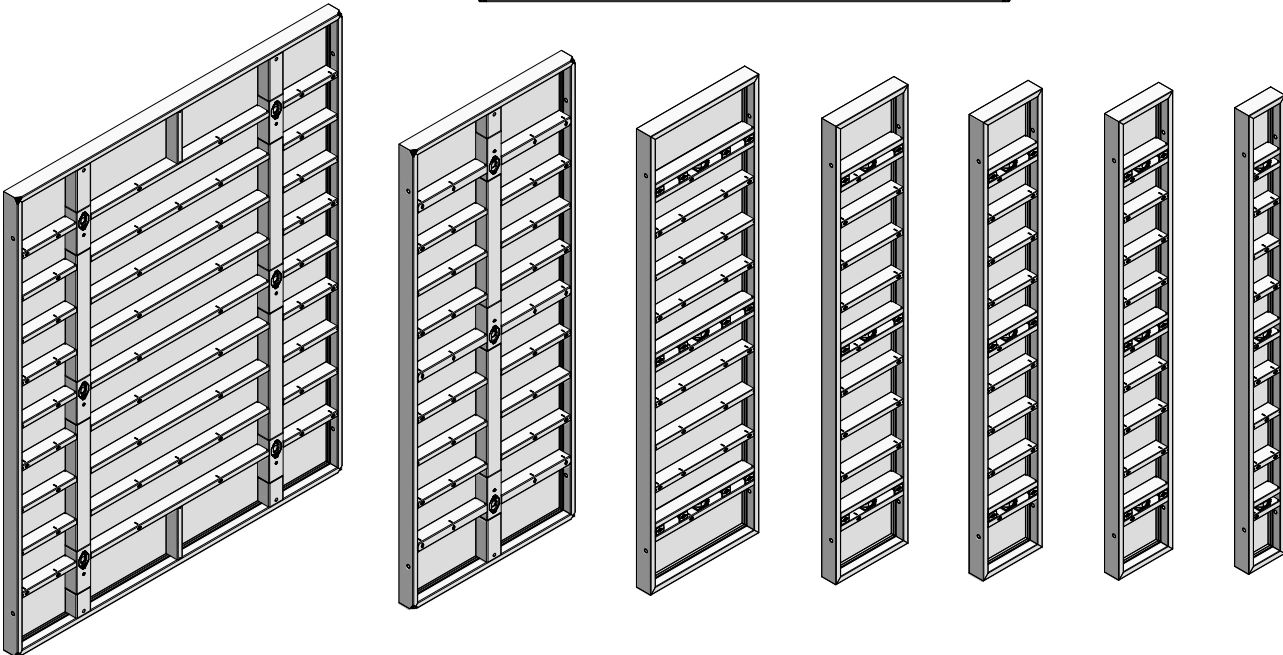
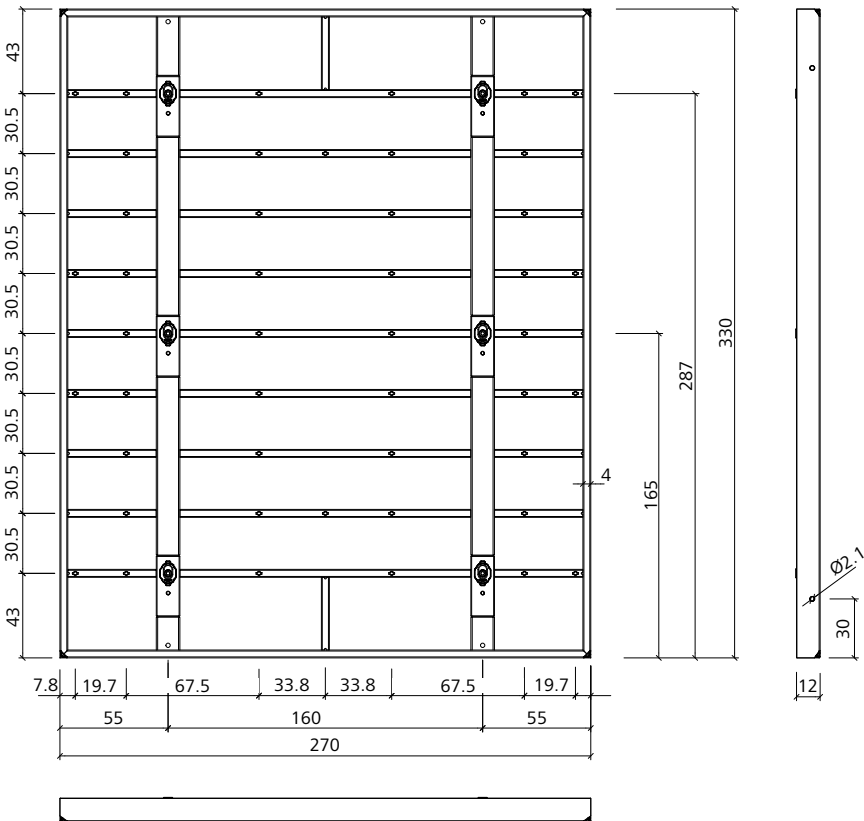

Wall formwork

Panel height 270 cm

Seven cross stiffeners with DW threaded nuts serve as multi-function profiles. Two internal combination tie holes with rotating body for each panel height.

Attention

Unused tie holes must always be closed with plug D35/38.

Ref.-No.	Description / Application	m ²	kg
21-202-03	StarTec XT AL 20 270/240	6.48	401.40
21-202-06	StarTec XT AL 20 270/135	3.65	242.45
21-202-11	StarTec XT AL 17 270/90	2.43	119.00
21-202-41	StarTec XT AL 17 270/60	1.62	86.55
21-202-53	StarTec XT AL 17 270/49	1.32	78.25
21-202-56	StarTec XT AL 17 270/45	1.22	76.00
21-202-71	StarTec XT AL 17 270/30	0.81	61.30

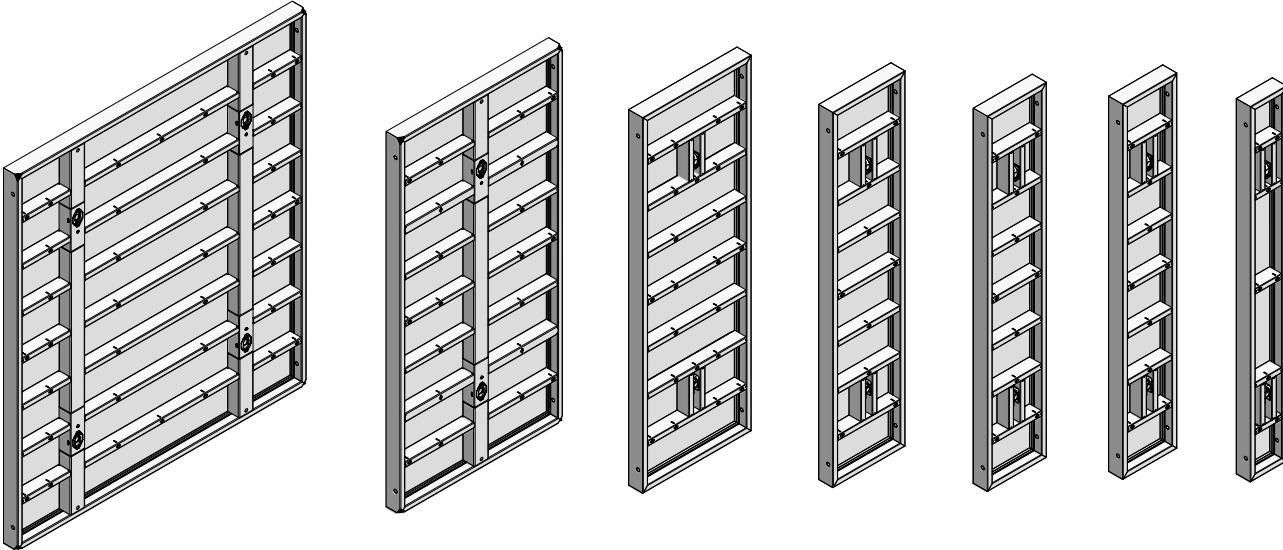
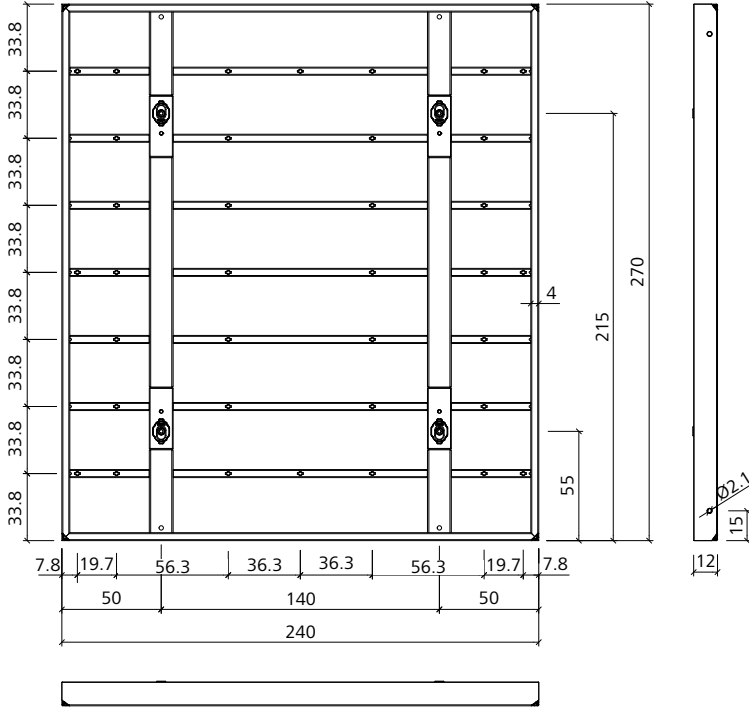

Panel height 135 cm

Three cross stiffeners with DW threaded nuts serve as multi-function profiles.
One internal combination tie hole with rotating body for each panel height.

Attention

Unused tie holes must always be closed with plug D35/38.

Ref.-No.	Description / Application	m ²	kg
21-203-01	StarTec XT AL 20 135/330	4.46	294.00
21-203-03	StarTec XT AL 20 135/240	3.24	214.65
21-203-06	StarTec XT AL 20 135/135	1.82	129.00
21-203-11	StarTec XT AL 17 135/90	1.22	62.85
21-203-41	StarTec XT AL 17 135/60	0.81	45.85
21-203-53	StarTec XT AL 17 135/49	0.66	41.85
21-203-56	StarTec XT AL 17 135/45	0.61	41.10
21-203-71	StarTec XT AL 17 135/30	0.41	31.50

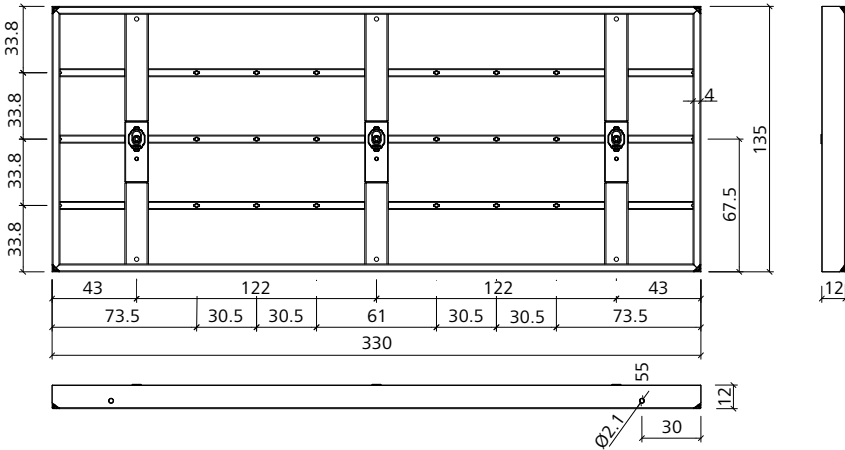
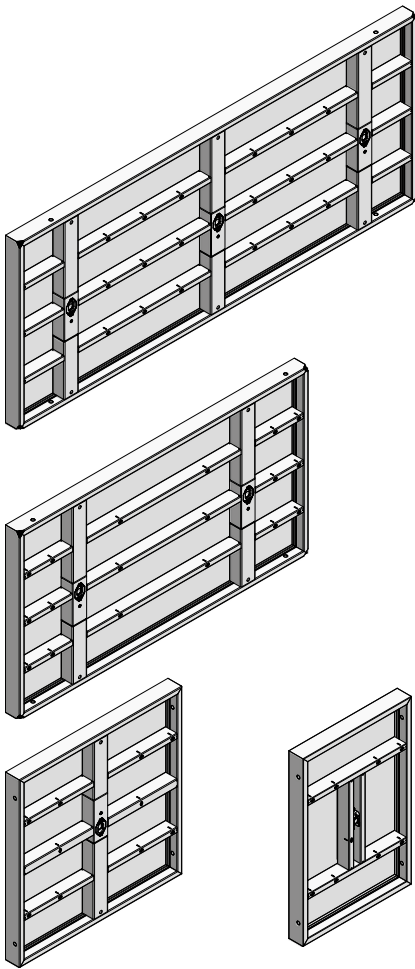

Foundation tape

Galvanized, hole spacing 50 mm, hole Ø 16 mm, length 50 m, to be cut at hole centre, permissible tensile force 10 kN. Serves together with the appropriate tensioner as the lower anchor of horizontal panels.

Ref.-No.	Description / Application	m ²	kg
29-307-50	Foundation tape 50 m.....		20.00

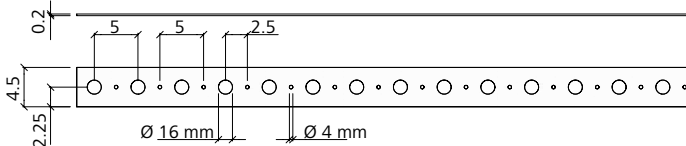
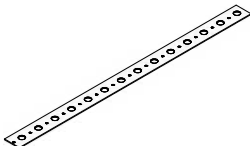

Wall formwork

Tensioner AS/ST for foundation tape

Galvanized. Connects the foundation tape to AluStar or StarTec panels and serves as bottom anchoring when panels are assembled in horizontal position. Two tensioners are required per anchoring position.

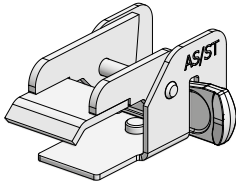

Ref.-No.	Description / Application	m ²	kg
29-307-70	Tensioner AS/ST for foundation tape	1.35	

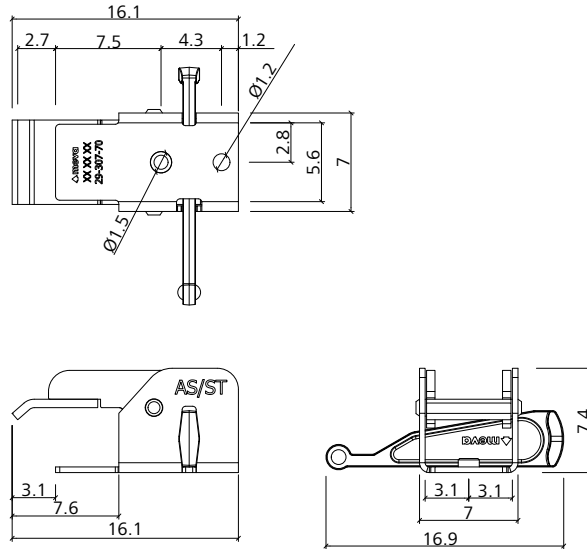

Trolley for foundation tape

Not shown. Galvanized. Is used to transport and cut foundation tape to length. Suitable for one roll. Pneumatic wheels.

Ref.-No.	Description / Application	m ²	kg
29-307-55	Trolley for foundation tape	21.80	

AS/ST aluminium filler

Aluminium with high-quality annealed powder coating. With tie holes. For length compensation of 5 cm, especially in corners. 2 or 3 Uni-assembly locks are required for each filler.

Ref.-No.	Description / Application	m ²	kg
21-270-57	AS/ST aluminium filler 330/8	0.26	11.00
21-270-56	AS/ST aluminium filler 330/6	0.20	9.90
21-270-58	AS/ST aluminium filler 330/5	0.17	9.41
21-270-54	AS/ST aluminium filler 330/4	0.13	8.70
21-270-62	AS/ST aluminium filler 270/8	0.22	9.10
21-270-61	AS/ST aluminium filler 270/6	0.16	8.10
21-270-60	AS/ST aluminium filler 270/5	0.14	7.73
21-270-59	AS/ST aluminium filler 270/4	0.11	7.20
21-270-67	AS/ST aluminium filler 135/8	0.11	4.80
21-270-66	AS/ST aluminium filler 135/6	0.08	4.20
21-270-65	AS/ST-aluminium filler 135/5	0.07	4.00
21-270-64	AS/ST aluminium filler 135/4	0.05	3.70

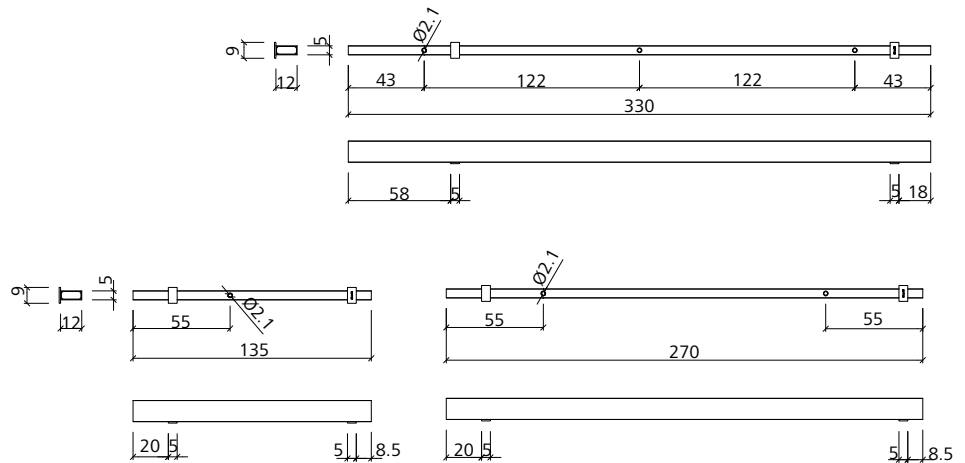
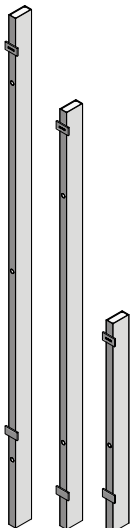

Wall formwork

AS/ST timber profile

Timber profile with groove. Is used for job-built fillers of 14 cm or more or to connect job-built formwork with 21 mm forming face. 2 or 3 AS assembly locks are required for each timber profile. Delivery and weight by pairs.

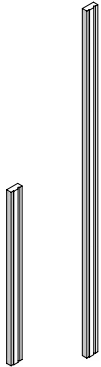

Ref.-No.	Description / Application	m ²	kg
29-200-07	AS/ST-timber profile 330/21	6.40	
29-200-03	AS/ST-timber profile 270/21	5.50	
29-200-05	AS/ST-timber profile 135/21	2.70	

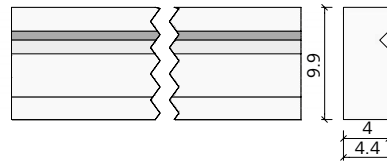

StarTec inside corner

For 90° corners. Side length 25 cm. Steel frame with tie holes and alkus facing or exchangeable steel sheet.

Ref.-No.	Description / Application	m ²	kg
21-251-00	StarTec AL-IC.....330/25	1.65	88.50
21-251-05	StarTec AL-IC.....270/25	1.35	68.00
21-251-35	StarTec AL-IC.....135/25	0.68	38.00

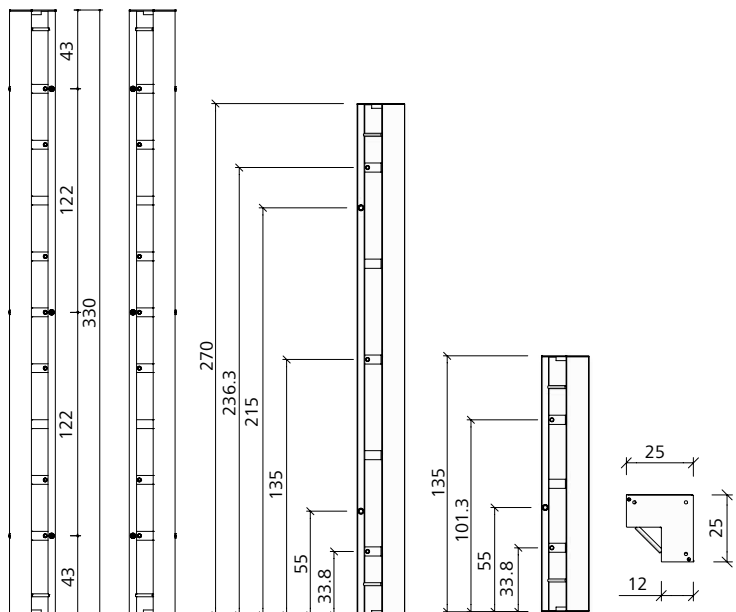
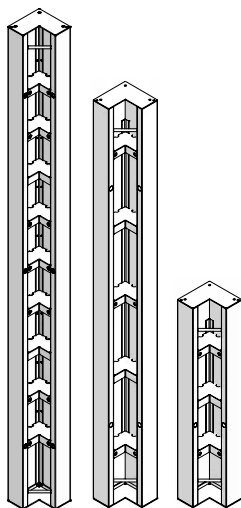

AS/ST outside corner

Aluminium. Facing 0 cm, 5 cm or 10 cm wide on both sides, integrated chamfer strip. Provides together with StarTec XT panels and AS assembly locks a fast and tight outside corner assembly for 90° angles.

Ref.-No.	Description / Application	m ²	kg
22-140-48	AS/ST outside corner alu 330/10	0.66	31.93
22-140-15	AS/ST outside corner alu 330/5	0.33	19.71
22-140-10	AS/ST outside corner alu 330		15.60
22-140-50	AS/ST outside corner alu 270/10	0.54	26.30
22-140-25	AS/ST outside corner alu 270/5	0.27	16.20
22-140-20	AS/ST outside corner alu 270		13.00
22-140-52	AS/ST outside corner alu 135/10	0.27	13.60
22-140-35	AS/ST outside corner alu 135/5	0.14	8.50
22-140-30	AS/ST outside corner alu 135		6.80

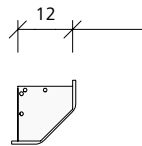
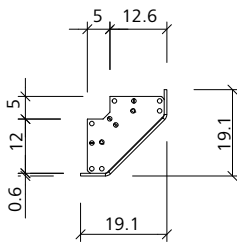
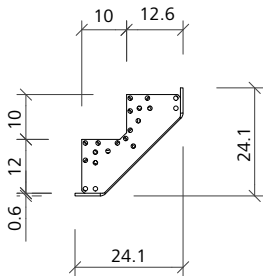
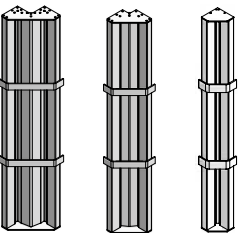
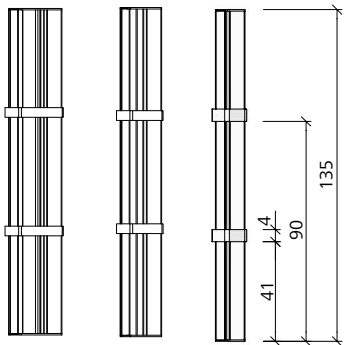
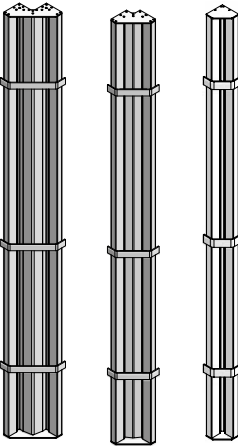
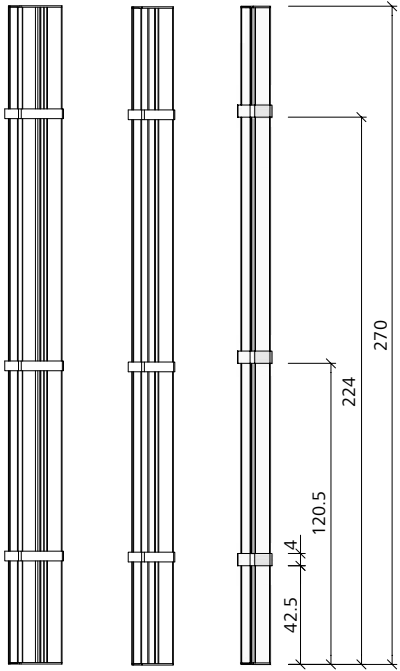
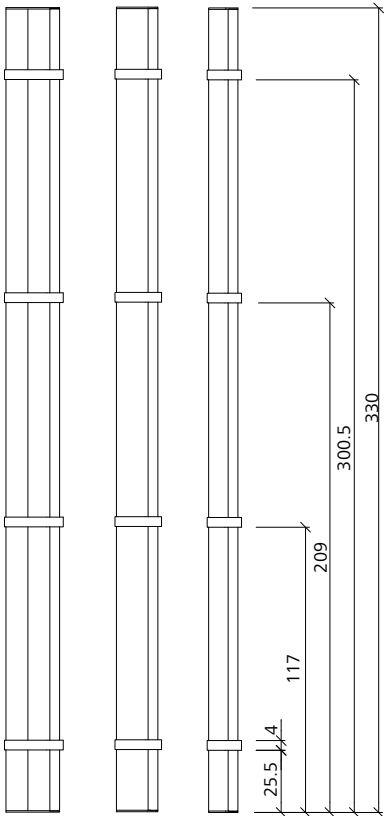
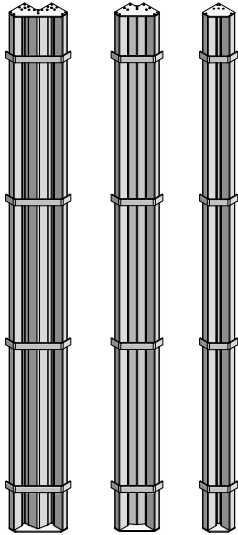

AS hinged inside corner

Steel construction with steel sheeting. Side length 30 cm. Adjustable angle 60° - 180°.

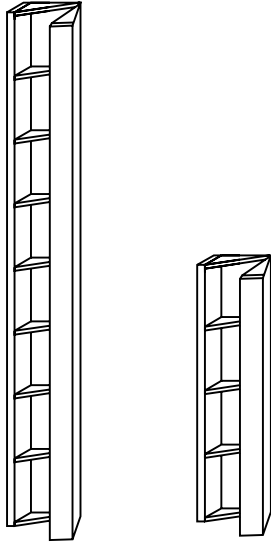

Ref.-No.	Description / Application	m ²	kg
21-270-20	StarTec HIC..... 330/30	1.98	118.70
21-270-00	AluStar HIC..... 270/30	1.62	75.00
21-270-10	AluStar HIC..... 135/30	0.81	38.20

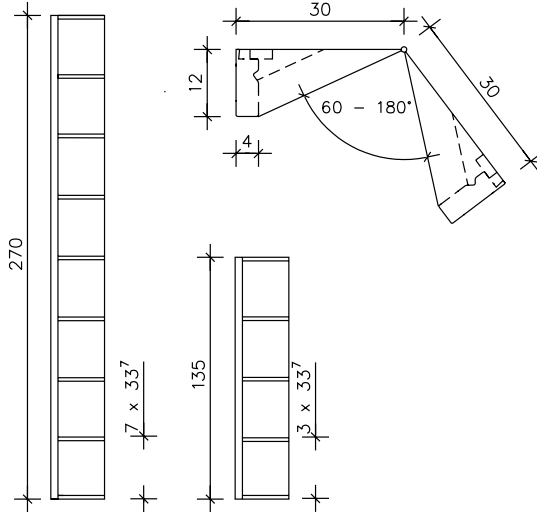

AS hinged outside corner

Steel construction with steel sheeting. Side length 7.5 cm. Adjustable angle 60° - 180°.

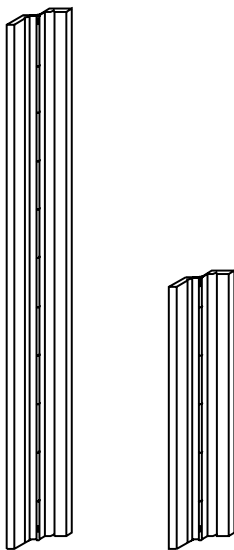

Ref.-No.	Description / Application	m ²	kg
21-280-20	StarTec HOC..... 330/7,5	0.50	60.30
21-280-00	AluStar HOC..... 270/7,5	0.41	47.70
21-280-10	AluStar HOC..... 135/7,5	0.20	23.80

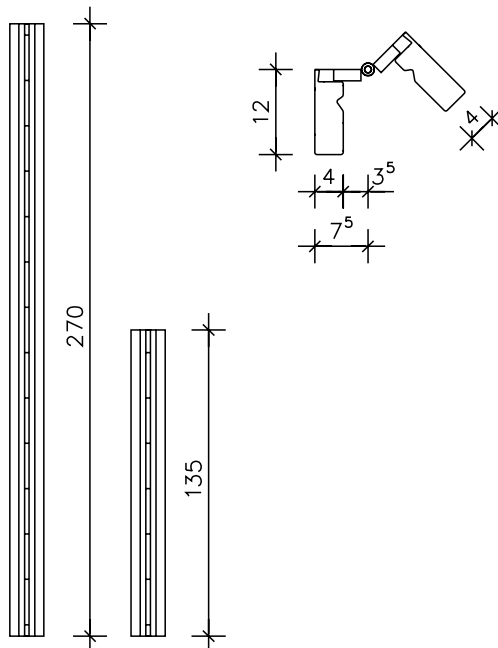

Wall formwork

StarTec stripping corner

Steel construction with steel sheeting. Side length 25 cm. With tie holes. When the bell-crank lever is pushed upwards with a crow-bar, the corner is removed 17.5 mm away from the concrete and the formwork 35 mm away from the concrete on both sides.

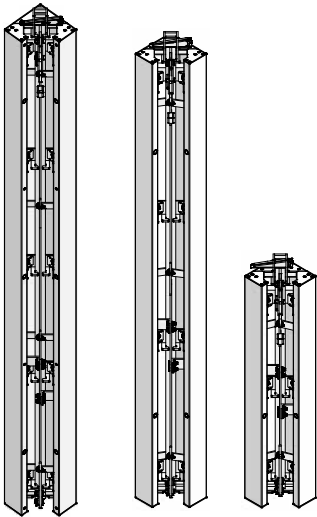

Ref.-No.	Description / Application	m ²	kg
21-262-05	StarTec SC 330/25	1.65	172.00
21-262-10	StarTec SC 270/25	1.35	146.00
21-262-30	StarTec SC 135/25	0.68	82.00

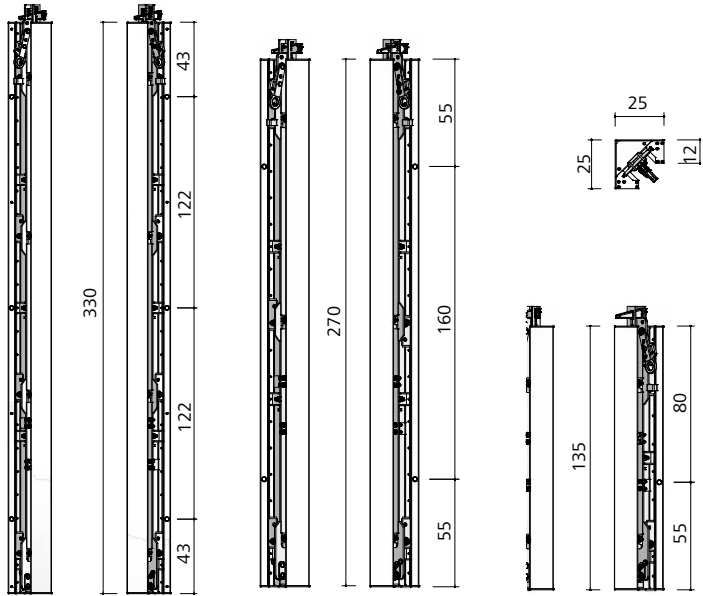

Adhesive tape, red

Not shown. Reinforced adhesive tape, red, 50 mm wide, 50 running metres. Total thickness: 270 µm. Natural rubber adhesive on one side. PE-coated.

Ref.-No.	Description / Application	m ²	kg
41-912-10	Adhesive tape 50 m, red	0.83	

Stripping corner tool

Is used to easily activate the stripping corner from above. It can be activated and returned to its original position. It is operated with a power screwdriver, a ratchet wrench or a spanner (SW 36).

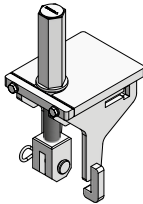

Ref.-No.	Description / Application	m ²	kg
29-306-32	Stripping corner tool	6.60	

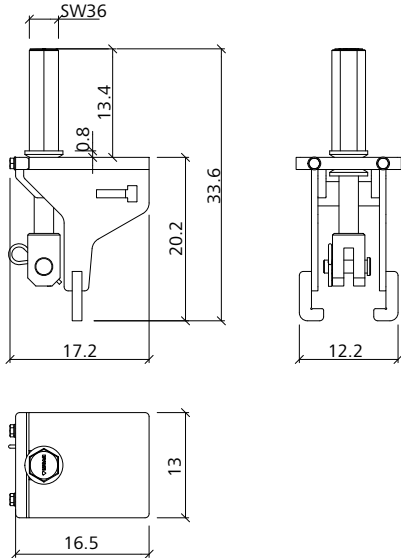

Wall formwork

AS assembly lock

Galvanized. Tightly connects and aligns AluStar and StarTec panels. Clamping length 8 cm.

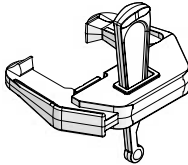

Ref.-No.	Description / Application	m ²	kg
29-205-00	AS-assembly lock		2.00

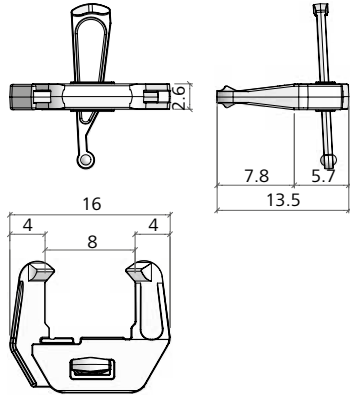

Uni-assembly lock

Galvanized. For stepless compensation. Clamping length 22 cm or 28 cm.

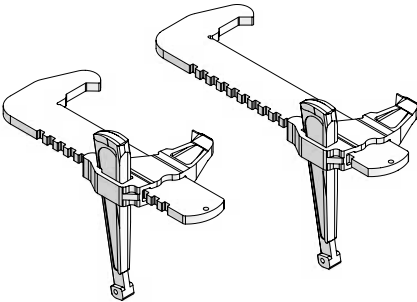

Ref.-No.	Description / Application	m ²	kg
29-400-85	Uni-assembly lock 22		3.60
29-400-90	Uni-assembly lock 28		3.90

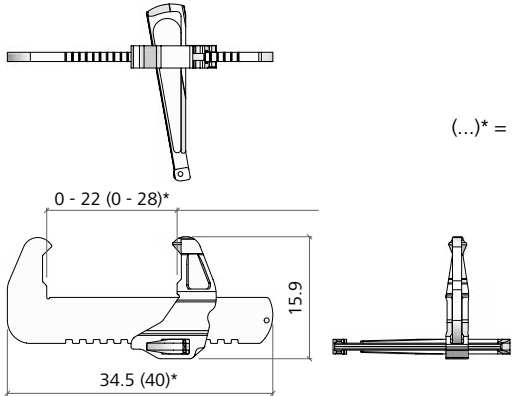

RS-assembly lock

Galvanized, For stepless length compensation. Clamping length is 11.9 to 20.5 cm for stepless compensation.

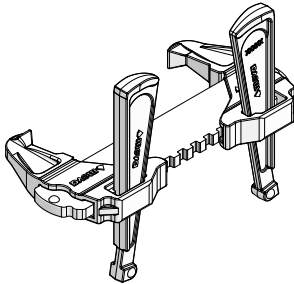

Ref.-No.	Description / Application	m ²	kg
23-807-70	RS-assembly lock		4.70

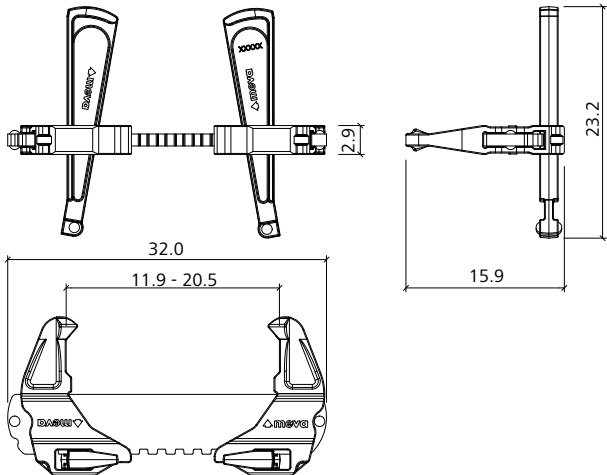

Wall formwork

Flange screw

Galvanized. Is used to attach accessories, e.g. alignment rails, brace frames, push-pull props, etc. Length of thread 18 cm or 27 cm.

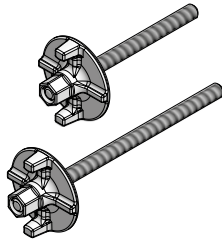

Ref.-No.	Description / Application	m ²	kg
29-401-10 Flange screw 18		1.02
29-401-12 Flange screw 28		1.28

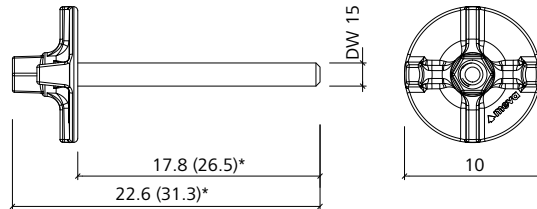

(..)* = 29-401-12

M-cross stiffener 44

Galvanized. Short alignment rail used to brace panel joints for crane ganging and to reinforce length compensations.

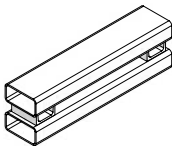

Ref.-No.	Description / Application	m ²	kg
29-401-02 M cross stiffener 44		6.30

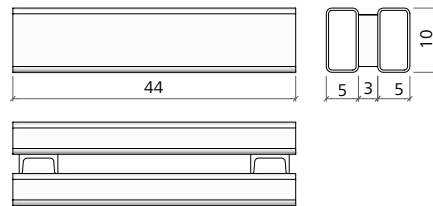

Stop end bracket

Galvanized. Is used to form stop ends. Stop end bracket 23/40 for wall thickness up to 30 cm. Stop end bracket 40/60 for wall thickness up to 40 cm.

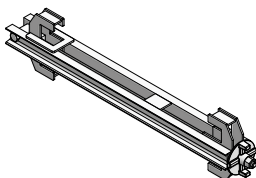
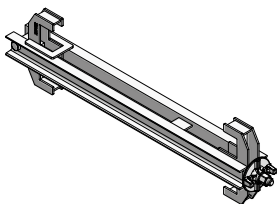

Ref.-No.	Description / Application	m ²	kg
29-105-50 Stop end bracket 40/60		15.10
29-105-45 Stop end bracket 23/40		13.40

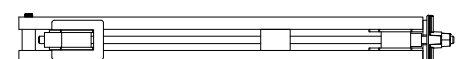
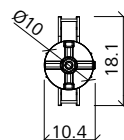
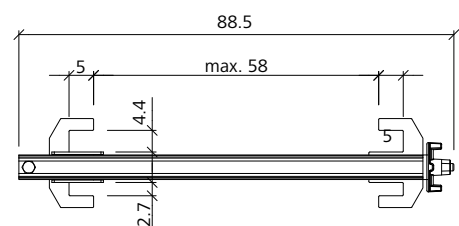
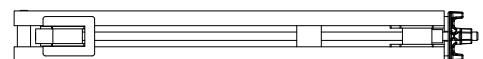
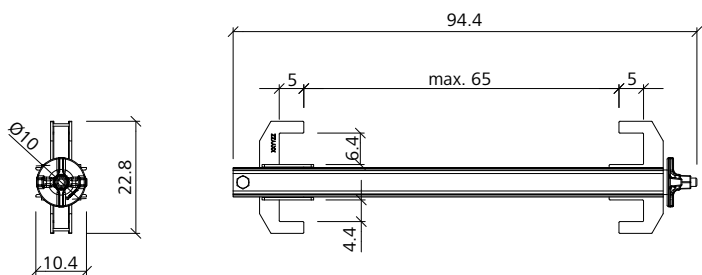

Wall formwork

Plug D20

Is used to close unused tie holes.



Ref.-No.	Description / Application	m ²	kg
29-902-63 Plug D20 red.....		0.01
29-902-71 Plug D35/38.....		0.01
29-902-72 Plug D35/38 without imprint.....		0.01
29-902-62 Plug D20 without imprint.....		0.01

Alignment rail

Galvanized. Is used to brace panel joints for crane ganging, bridge problem areas, brace compensation areas and build stop ends with stop end fixtures. Is attached to the formwork with flange screws.

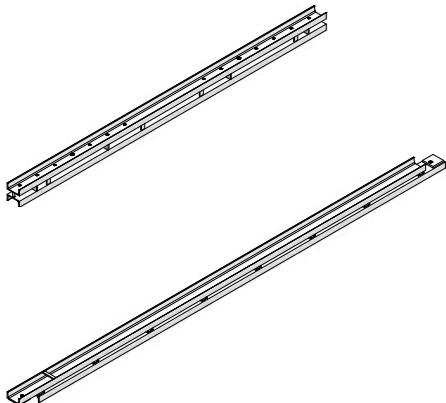
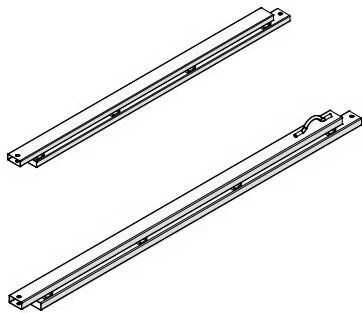
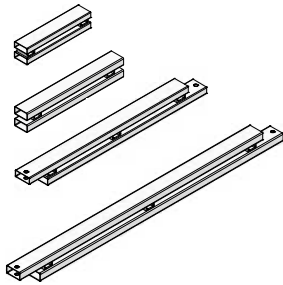

Ref.-No.	Description / Application	m ²	kg
29-201-73 AS-alignment rail 50, galv.....		5.20
29-400-95 M-alignment rail 75, galv.....		11.00
29-201-75 AS-alignment rail 125, galv.....		10.50
29-400-92 M-alignment rail 180, galv.....		24.80
29-201-80 AS-alignment rail 200, galv.....		19.00
29-402-50 M-alignment rail 250, galv.....		34.50
29-402-45 M-alignment rail 350, reinforced.....		124.00
29-402-38 M-alignment rail 450, reinforced.....		159.00

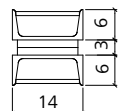
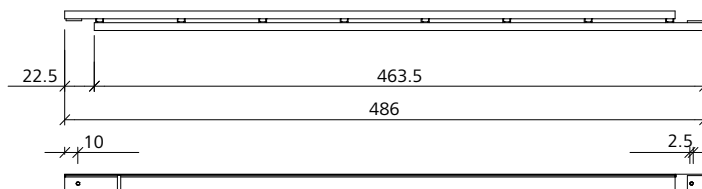
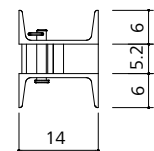
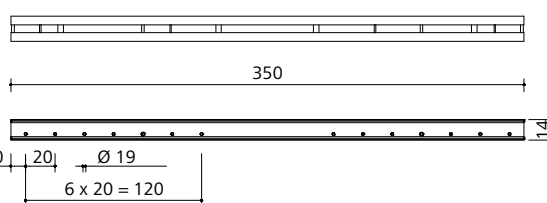
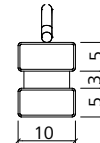
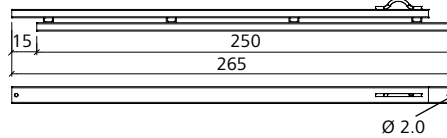
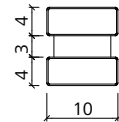
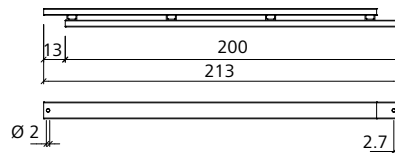
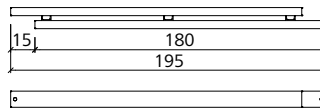
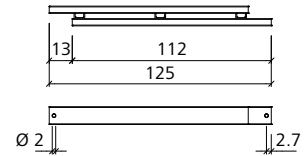
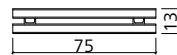
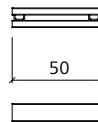

Wall formwork

Support angle for walkway brackets

Galvanized. Is used to support a walkway bracket if the DW-nut on the multi-function bracket profile is covered by an alignment rail. In this case the mounting bracket is fixed to the panel through the alignment rail by a separate flange screw.

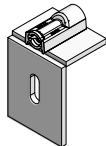

Ref.-No.	Description / Application	m ²	kg
29-106-95 Support angle for walkway brackets.....		2.70

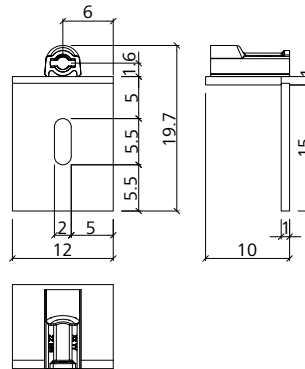

Spacer

Aluminum-sheet to maintain the distance between the wall thickness. Is inserted between the formwork at the top. For wall thickness 25 cm and 30 cm or 20 cm and 24 cm.

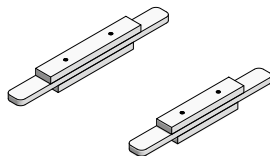

Ref.-No.	Description / Application	m ²	kg
29-901-62 Spacer 25/30 AL20/17.....		0.72
29-901-52 Spacer 20/24 AL20/17.....		0.60

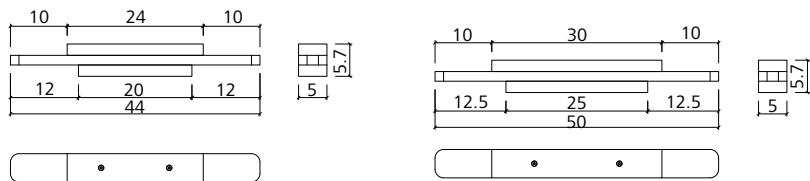

Tie rod fixture

Galvanized. To hold DW tie rods with articulated flange nut, XT tie rods or XT taper ties. Can be used with horizontal or vertical MEVA wall formwork panels.

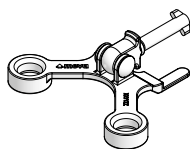

Ref.-No.	Description / Application	m ²	kg
29-927-05 Tie rod fixture Ø35.....		1.20

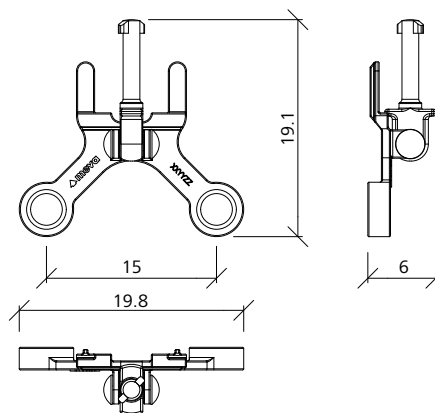

Wall formwork

XT tie rod DW 20

Uncoated, with DW 20 thread. DIN 18216, not weldable. Used for single-sided and conventional tying of panels on double-sided formwork. Permissible load 160 kN. With integrated articulated flange nut. Length = 75 cm for wall thickness up to 40 cm, Length = 120 cm for wall thickness up to 85 cm.

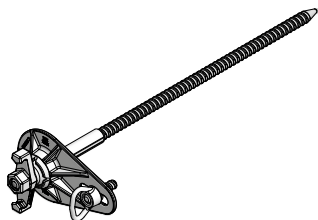

Ref.-No.	Description / Application	m ²	kg
23-154-35XT tie rod DW 20/75		4.75
23-154-40XT tie rod DW 20/120		5.89

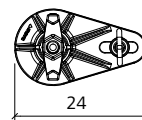
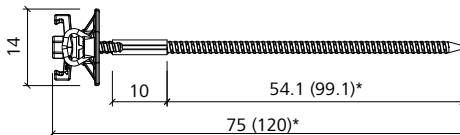

(...)* = 23-154-40

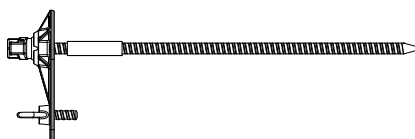

XT cone DW 20

PE; used on the initial formwork of StarTec XT when using the XT tie rod DW 20 in order to set the distance. Replaces XT sleeve (29-902-36).



Ref.-No.	Description / Application	m ²	kg
29-902-37XT cone DW 20.....		0.02

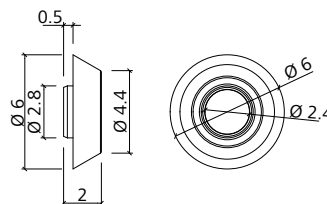

Plastic tube

Plastic tube for use as an anchor sleeve for a XT tie rod DW 20.

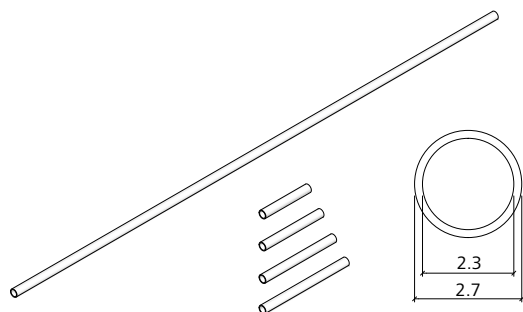

Ref.-No.	Description / Application	m ²	kg
29-902-31Plastic tube D23/200		0.44
29-902-03Plastic tube D23/18		0.04
29-902-04Plastic tube D23/23		0.05
29-902-05Plastic tube D23/28		0.06
29-902-06Plastic tube D23/33		0.08

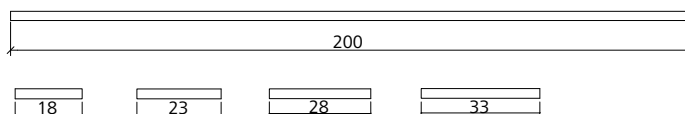

Wall formwork

XT taper tie 23/...

Coated, with DW thread and conical, smooth middle section. Used for single-sided tying of panels on double-sided formwork. Permissible load 160 kN. With Adjustment screw for precise wall thickness adjustment between 15 - 25 cm, 20 - 30 cm, 35 - 45 cm, 45 - 55 cm and 60 - 70 cm.

Ref.-No.	Description / Application	m ²	kg
23-154-60XT taper tie 23/15-25.....	5.71	
23-154-65XT taper tie 23/20-30.....	5.94	
23-154-70XT taper tie 23/35-45.....	6.63	
23-154-75XT taper tie 23/45-55.....	7.10	
23-154-80XT taper tie 23/60-70.....	7.90	

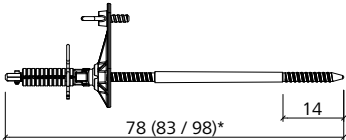
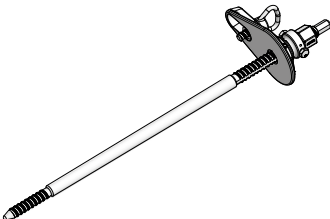
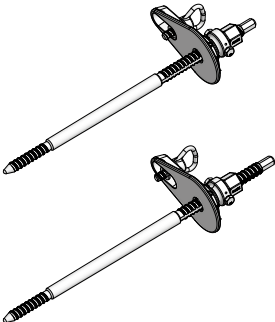
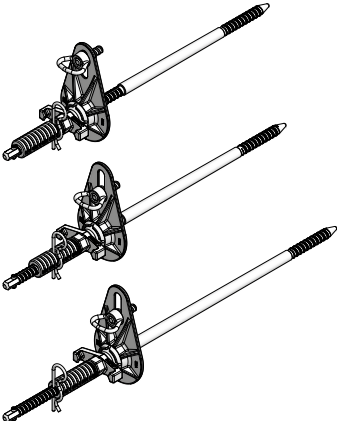

(...)* = 29-154-15 / 29-154-20

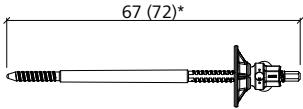
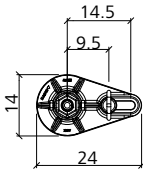

(...)* = 23-154-65

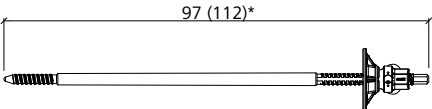
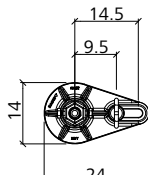
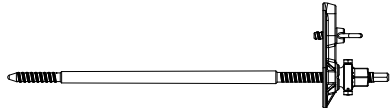
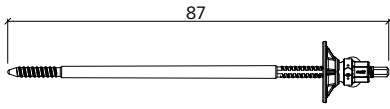
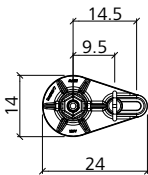
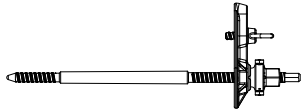

(...)* = 23-154-80



Wall formwork

XT-Taper Tie Ratchet Spanner SW 17 & SW 19

Not shown, tool set used to tighten and loose XT taper ties. It consists of: Ratchet spanner, chrome-plated and polished, length 53 cm. Spanner socket AF17, black-oxidized for XT taper ties 20. Spanner socket AF19, black-oxidized for XT taper ties 23.

Ref.-No.	Description / Application	m ²	kg
29-800-25XT taper tie Ratchet spanner SW 17 & SW 19	3.00

Divinol Wax

Not shown. Paste-like solvent-based wax suitable for all formwork (wood, steel, plastic-coated). Rain resistant. Recommended for use on the XT taper ties.

Ref.-No.	Description / Application	m ²	kg
29-203-30 Divinol pasty wax	1.10

FB-Aktivstop XT 20 SET

Plug made of fibre concrete with an integrated expansion seal to close tapered openings in the wall incl. hammering aid. Only suitable for XT taper tie 20/...

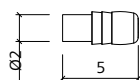
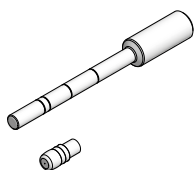

Ref.-No.	Description / Application	m ²	kg
29-902-41 FB-Aktivstop XT 20 SET	3.50

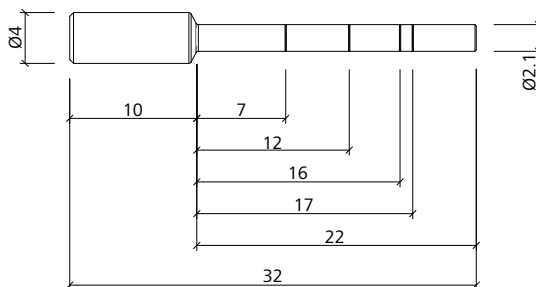

MEVA Multi-Stopp 23

TPE – thermoplastic elastomer, Concrete grey. Tie holes plugs that seal against hydrostatic pressure when using the XT taper tie 23 (hammering aid is available separately). Can be used in conjunction with XT sealing cone 5 or XT sealing cone 10. Resistant, inter alia, to salt water, diesel, bitumen and caustic soda lye.

Ref.-No.	Description / Application	m ²	kg
29-902-43 MEVA Multi-Stopp 23	0,04



Wall formwork

XT sealing cone

Plastic. Used to seal the tie holes when using the XT tie rod and the XT taper tie.

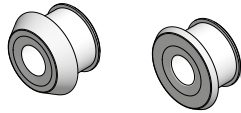

Ref.-No.	Description / Application	m ²	kg
29-902-35XT sealing cone 10 AL20.....		0.01
29-902-34XT sealing cone 5 AL20.....		0.01
29-902-42XT-sealing cone 10 AL17.....		0.01
29-902-33XT-sealing cone 5 AL17.....		0.01

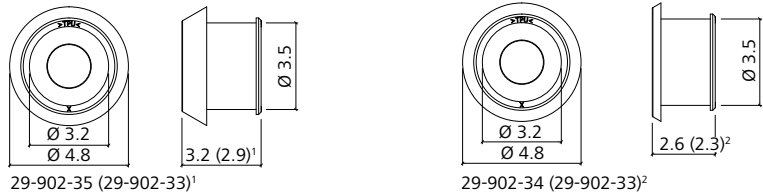

XT fibre concrete plug 47 x 8,5

Nor shown. Made of fibre concrete, to close anchor points on the walls when using XT-seal cones 10 (29-902-35), the plugs are glued in place by concrete glue A + B (53-210-70)

Ref.-No.	Description / Application	m ²	kg
29-902-82XT fibre concrete plug 47 x 8,5.....		0.03

Concrete glue A + B

Not shown. 2-component concrete glue for fair-faced concrete plugs. Quantity is sufficient for 150 plugs.

Ref.-No.	Description / Application	m ²	kg
53-210-70Concrete glue (A + B).....		1.00

XT plug D46

Grey plastic. Used to close the tie holes in the concrete when using XT DW tie rods with plastic tubes or when using XT taper ties. The XT plug D46 is recessed in the shadow gap. Two sealing plugs are required per anchor point.

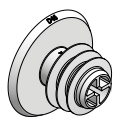

Ref.-No.	Description / Application	m ²	kg
29-902-81XT plug D46.....		0.01

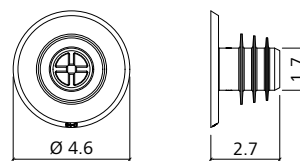

XT combi-lever

Galvanized. Used to rotate and adjust the XT tie hole.

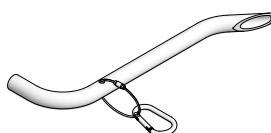

Ref.-No.	Description / Application	m ²	kg
23-154-90XT combi lever.....		0.30

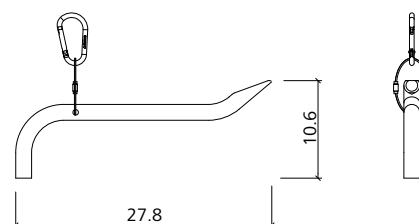

Wall formwork

Tie rod DW

Uncoated, not weldable; DIN 18216; with DW thread; admissible load capacity 160 kN (Ø 20 mm); is used to tie panels of a double-sided formwork.

Ref.-No.	Description / Application	m ²	kg
29-900-97	Tie rod DW 20/120		3.00

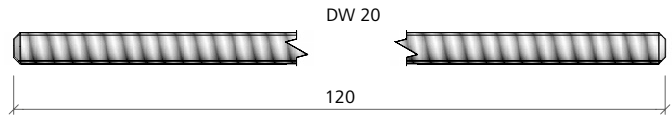

Articulated flange nut

Forged, galvanized. DIN 18216, with DW thread Ø 20 mm, plate Ø 140 mm, max. inclination 10°, WAF 36 mm. Permissible load 160 kN.

Ref.-No.	Description / Application	m ²	kg
29-900-05	Articulated flange nut 20/140		2.40

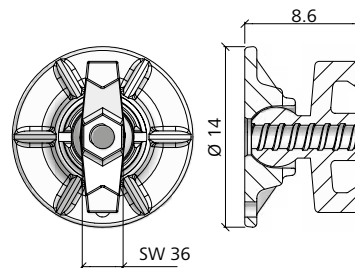
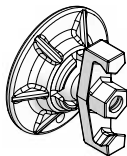

Cone for plastic tube

Available with 10 mm covering.

Ref.-No.	Description / Application	m ²	kg
29-902-55	Cone for plastic tube D32/10		0.01

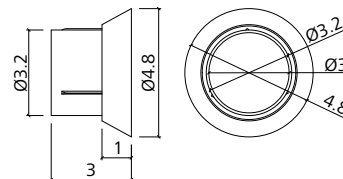

Plastic tube D32

Plastic tube for use as an anchor sleeve for a tie rod DW20.

Ref.-No.	Description / Application	m ²	kg
29-902-28	Plastic tube D32200		0.40

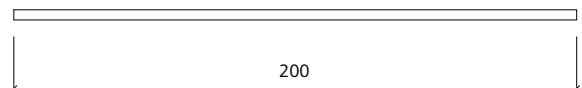
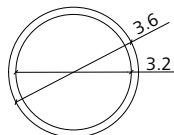
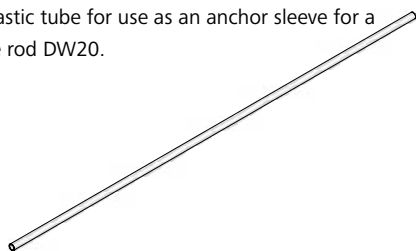

Plug

Is used to close tie holes in the wall when plastic tubes D32 are applied. Two plugs are required per tie hole.

Ref.-No.	Description / Application	m ²	kg
29-902-58	Plug D32		0.01



Wall formwork

Tie wrench DW20/DW23

Made of steel, galvanized. Used to screw in, screw out and hold tie rods DW20 and DW23; length 640 mm.

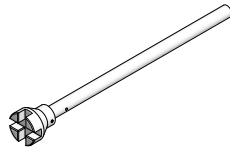

Ref.-No.	Description / Application	m ²	kg
29-901-39	Tie wrench DW20/DW23.....		3.10

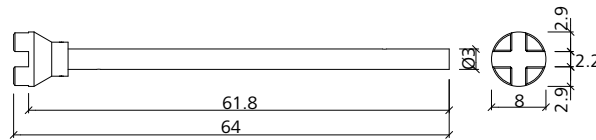

Spanner

Yellow chromatised bit. WAF 36 mm. Used to tighten and loosen XT tie rod DW 20 and articulated flange nuts 20/140.

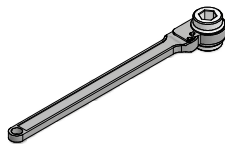

Ref.-No.	Description / Application	m ²	kg
29-800-15	Spanner SW 36		3.30

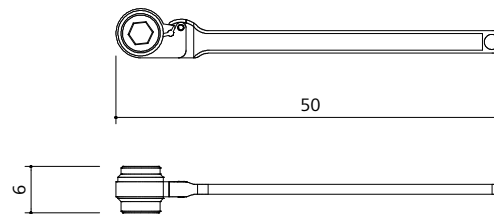

Uni-tie claw

Galvanized. Permits tying directly above or beside the panels. Is suited for panels with profile widths of 40 and 60 mm.

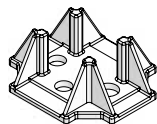

Ref.-No.	Description / Application	m ²	kg
29-901-41	Uni-tie claw.....		1.52

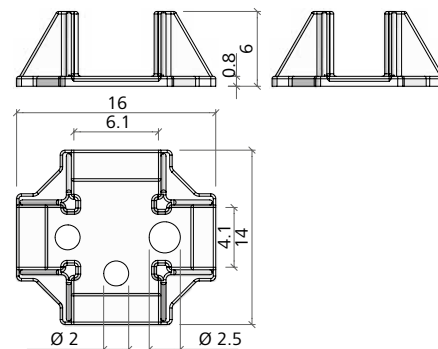

AS crane hook

Is used to move panels. Self-locking. Load capacity: 15 kN (1.5 tons). Always 2 crane hooks required per gang. For use and safety check see the Operating Instructions.

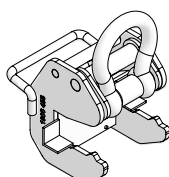

Ref.-No.	Description / Application	m ²	kg
29-203-89	AS-crane hook.....		5.95

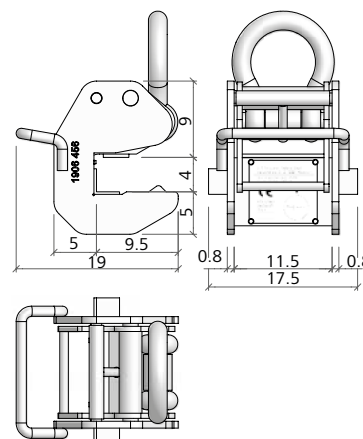

Wall formwork

Brace frame 250

Galvanized. Available with formwork-prop connector. Is used to align and brace the formwork. Consists of a push-pull prop R 250 (190 - 320 cm), a brace SRL 120 (90 - 150 cm) and a double-jointed footplate. The formwork-prop connectors are attached to the formwork with flange screws 18.

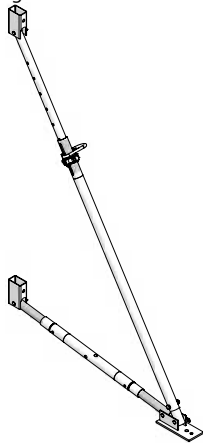

Ref.-No.	Description / Application	m ²	kg
29-109-20 Brace frame 250 with formwork-prop connector.....		31.50

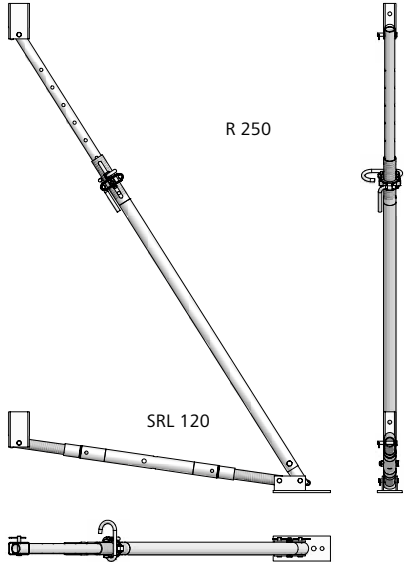

Formwork-prop connector

Galvanized. Including head bolt 16/90 and cotter pin 4. Used to connect brace frames, braces and push-pull props to the multi-function profile with flange screw 18. Maximum tube diameter of the braces and push-pull props is 48 mm.

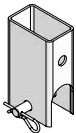

Ref.-No.	Description / Application	m ²	kg
29-804-85 Formwork-prop connector		1.65

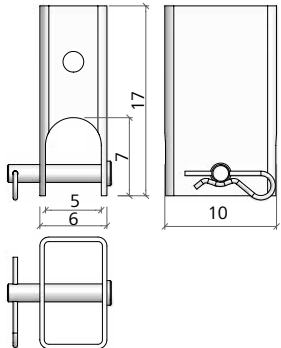

Double-jointed foot plate

Galvanized. Delivery includes head bolt 16/90 and cotter pin 4. Serves as foot plate for brace frames 250 and as connector for braces and push-pull props up to Ø 57 mm.

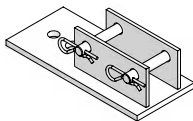

Ref.-No.	Description / Application	m ²	kg
29-402-32 Double-jointed foot plate (prop diam. up to 57 mm).....		4.00

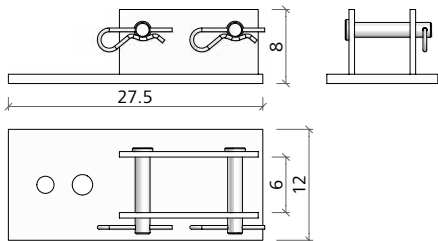

Wall formwork

Head bolt 16/90

Galvanized. Is used to attach push-pull props and braces to foot plates and formwork-prop connectors.



Ref.-No.	Description / Application	m ²	kg
42-413-50	Head bolt 16/90, galv.		0.17

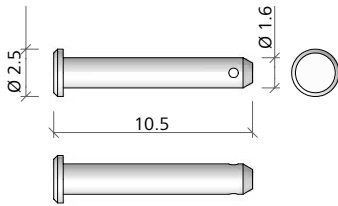

Cotter pin 4

Galvanized. Locks the head bolt.

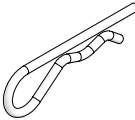

Ref.-No.	Description / Application	m ²	kg
62-010-04	Cotter pin 4		0.02

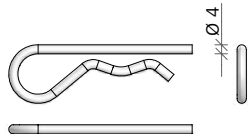

Collapsible clip 4.5

Not shown. Galvanized. Locks the head bolt.

Ref.-No.	Description / Application	m ²	kg
62-010-03	Collapsible clip 4.5		0.01

Walkway bracket

Galvanized, yellow, pluggable. Is used as working and safety scaffold. Is attached to the multi-function profile and secured to the multi-function profile below with a flange screw 18. The planking can be mounted to the brackets. Working width approx. 90 cm. MEVA Guardrailing post is also required. Bracket spacing depends on type of planking (DIN 4420).

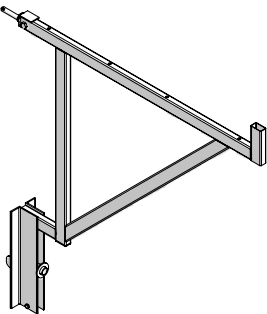

Ref.-No.	Description / Application	m ²	kg
29-106-00	Walkway bracket 90 (yellow), galv.		10.30

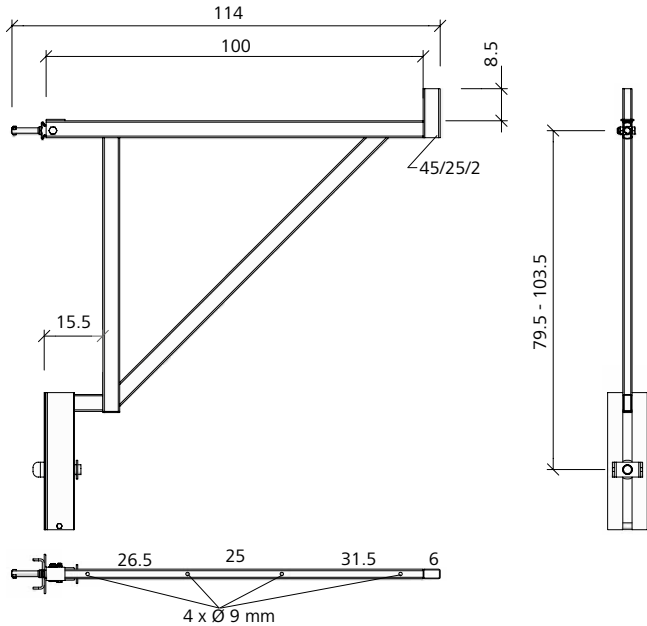

Wall formwork

Guardrailing post

Galvanized. Is plugged into the walkway bracket.

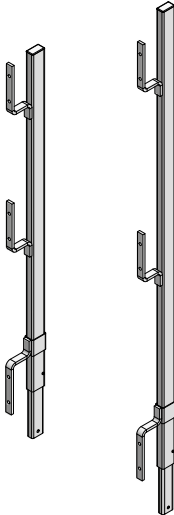

Ref.-No.	Description / Application	m ²	kg
29-106-75	Guard-railing post 100		3.70
29-106-85	Guard-railing post 140		4.70

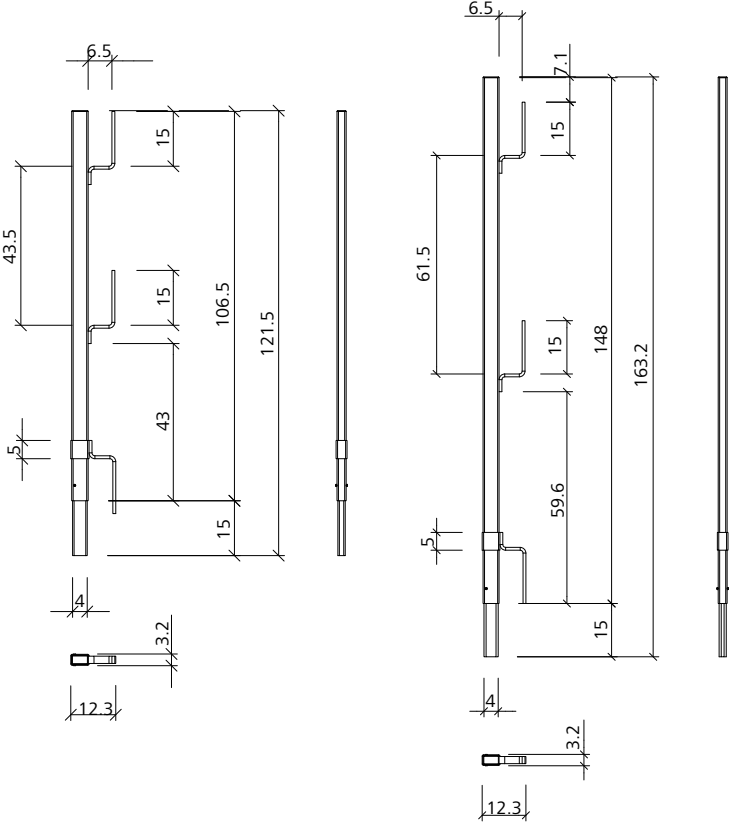

Guardrailing post 48

Galvanized. With manifold to attach it to the walkway bracket, designed with tube Ø 48 mm to attach tube couplers.



Ref.-No.	Description / Application	m ²	kg
29-106-80	Guard-railing post 48/120 (UK)		5.50

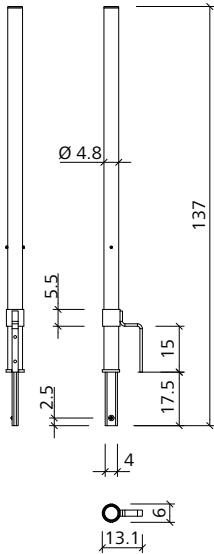

Wall formwork

Tilting bracket 40/60

Galvanised. Used to attach MEVA guardrailing posts to create a fall protection system. It can be set up vertically to facilitate the installation of safety meshes or railing boards or inclined by 15° to create a larger working area. Secured with a wedge to the frame profile of 40 and 60 mm.

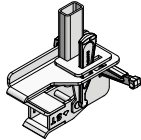

Ref.-No.	Description / Application	m ²	kg
29-920-82	Tilting bracket 40/60		4.90

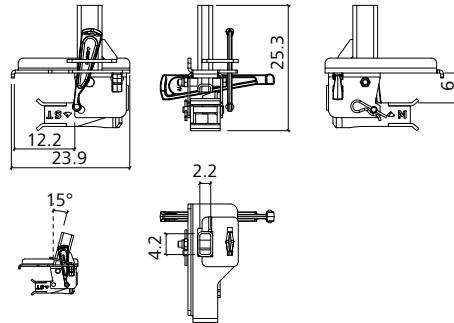

Side railing

Galvanized. Is plugged into the walkway bracket.

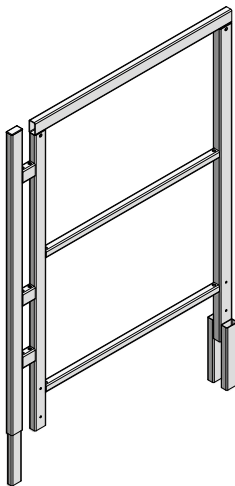

Ref.-No.	Description / Application	m ²	kg
29-108-20	Side railing 90/100, galv.		12.30

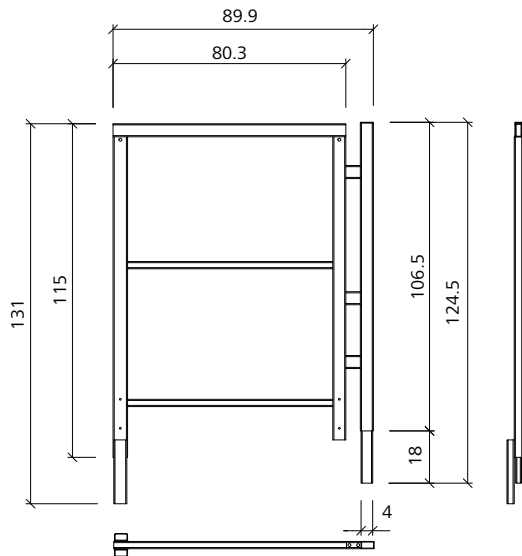

Wall formwork

Safety mesh

Painted steel. Robust steel mesh with reinforced edges and closed steel sheet to prevent small items from falling down. The mesh replaces railings, toe board and net in one single part. DIN EN 13374 Class A.

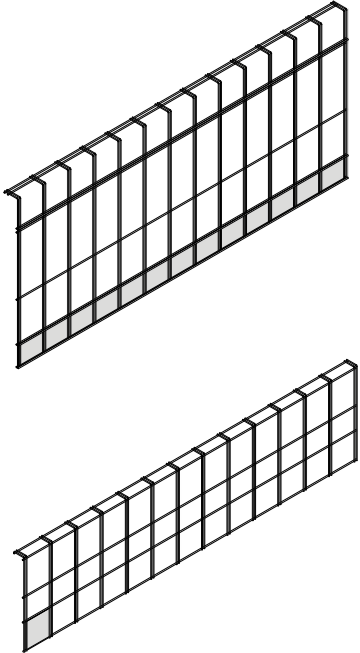

Ref.-No.	Description / Application	m ²	kg
29-920-00 Safety mesh 1100/2490	15.00	
29-920-05 Safety mesh 600/2490	9.80	

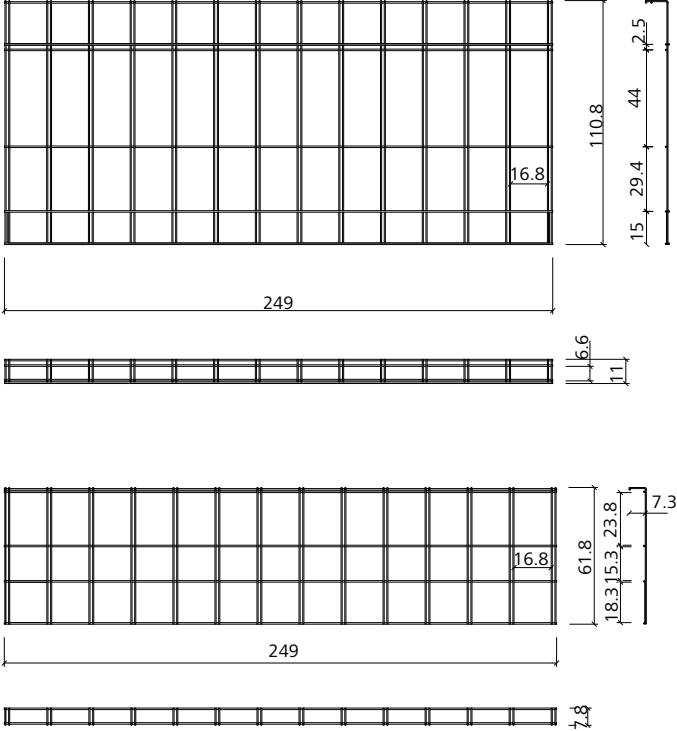

Universal shoe MFS

Galvanised; forms a fall protection device in conjunction with the MEVA guardrailing post and the safety mesh MFS. Can be used to provide lateral protection on horizontal and vertical components.

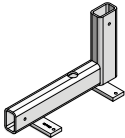

Ref.-No.	Description / Application	m ²	kg
29-921-72 Universal shoe MFS	2.10	

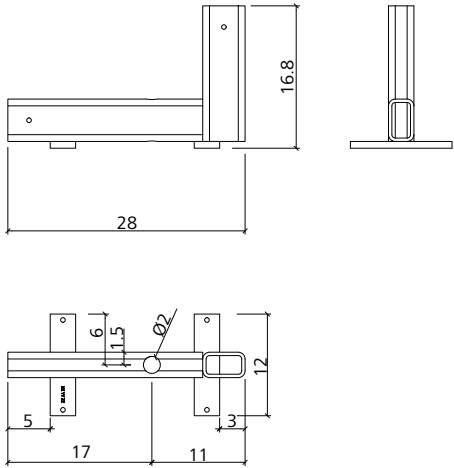

Wall formwork

Scaffold tube

Galvanized. Is used as hand-rail / mid-rail in combination with guardrailing post 48.

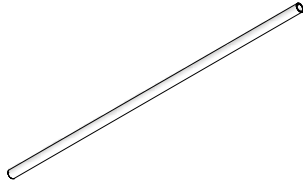

Ref.-No.	Description / Application	m ²	kg
29-412-23	Scaffold tube 48/200		9.40
29-412-26	Scaffold tube 48/300		14.10
29-412-27	Scaffold tube 48/400		18.80
29-412-25	Scaffold tube 48/500		23.50
29-412-28	Scaffold tube 48/600		28.20

Swivel-joint coupler 48/48

Galvanized. Connects 2 scaffold tubes with Ø 48.3 mm at any angle required.



Ref.-No.	Description / Application	m ²	kg
29-412-52	Swivel-joint coupler 48/48		1.20

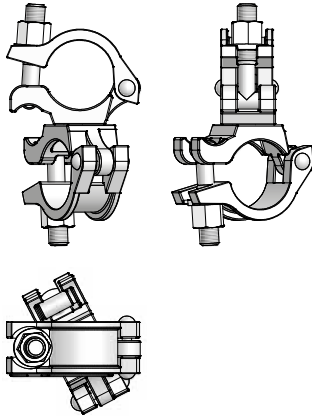

Stacking angle 60/40/23

Steel, galvanized. Used to stack and transport two to five wall formwork panels of the same size with frame profile widths of 60 mm, 40 mm or 23 mm. Four stacking angles 60/40/23 are required for each panel stack. The permissible load capacity per stacking angle is 15 kN (1.5 t). Refer to the stacking angle Operating Instructions for application and safety test.

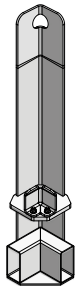

Ref.-No.	Description / Application	m ²	kg
29-305-45	Stacking angle 60/40/23		9.60

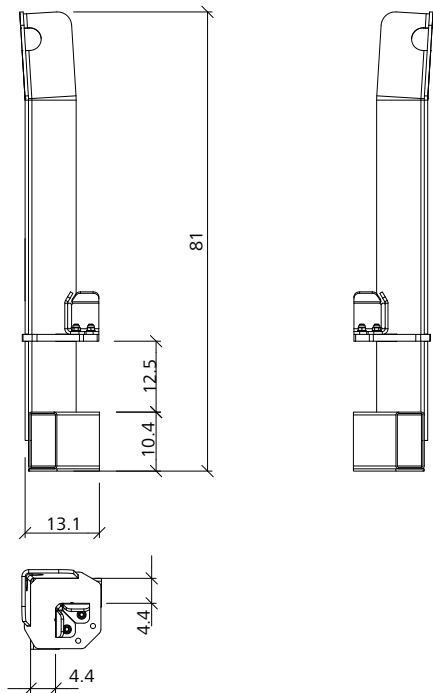

Wall formwork

Lifting hook 40

Galvanized. Allows any 4-rope crane slings available on site to be used to move the panel stacks. Always use 4 hooks at a time. Max. load capacity 10 kN (1 ton) per lifting hook. Max. weight of a panel stack 2 tons. Refer to the lifting hook Operating Instructions for application and safety test.

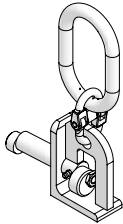

Ref.-No.	Description / Application	m ²	kg
29-401-42	Lifting hook 40		1.54

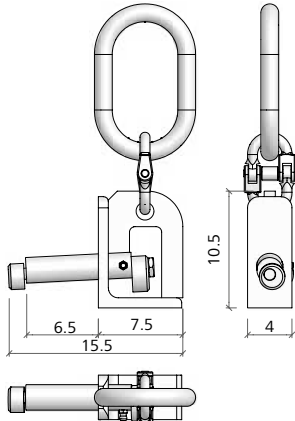

Ladder

Galvanized. Can be extended with extension ladders. Safety cages are required for operational safety.

Ref.-No.	Description / Application	m ²	kg
29-414-50	Ladder 348		23.20
29-414-55	Ladder 318		21.10
29-416-50	Ladder 243		17.20

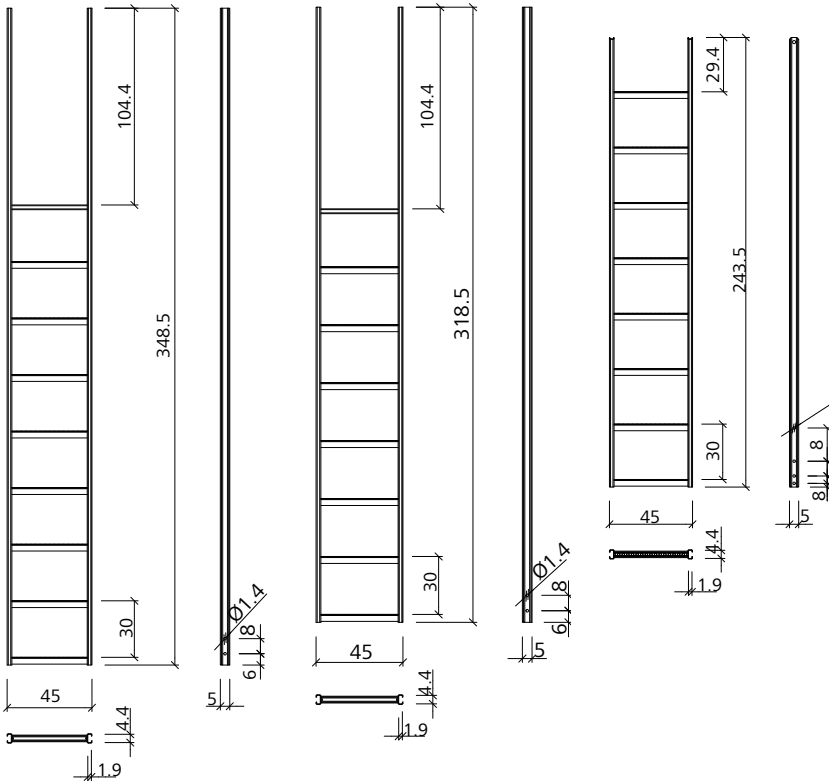
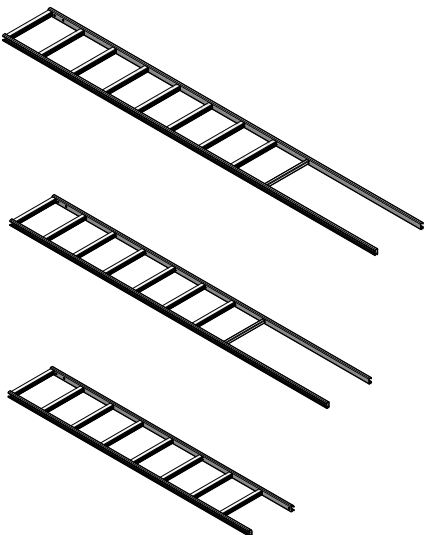

Wall formwork

Extension ladder

Galvanized. Depending on the required height, the extension ladder is either hooked into the steps of the ladder or bolted to the ladder with the ladder connector.



Ref.-No.	Description / Application	m ²	kg
29-416-52 Extension ladder 270.....	19.20	
29-414-60 Extension ladder 210.....	15.80	
29-416-55 Extension ladder 120.....	8.50	
29-416-60 Extension ladder 90.....	7.40	
29-416-62 Extension ladder 60.....	4.40	

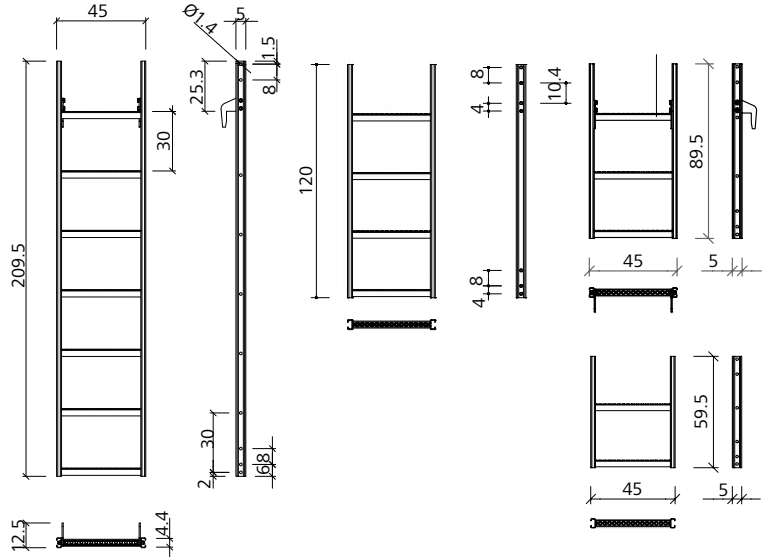

Ladder connector

Galvanized. Connects the joint of two extension ladders without the need to hook one ladder into a step of the other.

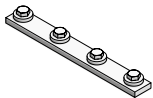

Ref.-No.	Description / Application	m ²	kg
29-414-70 Ladder connector.....	1.03	

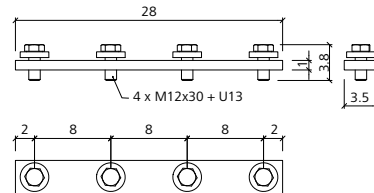

Safety cage

Galvanized. Internal Ø 70 cm. Protects workers when ascending and descending the ladder. The safety cages are attached to the (extension) ladders with the integrated hammerhead screws.

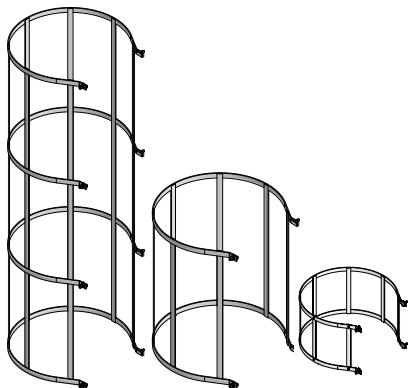

Ref.-No.	Description / Application	m ²	kg
29-414-85 Safety cage 210.....	27.60	
29-414-90 Safety cage 85.....	12.10	
29-416-90 Safety cage 40.....	8.20	

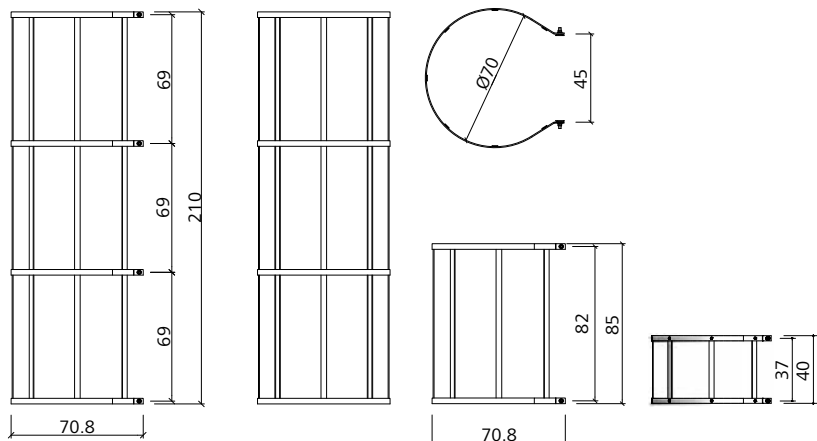

Wall formwork

Ladder fixture, upper wall formwork

Galvanized. Attached to the multi-function profile at the top of the horizontal or vertical panel to hold the ladder or extension ladder.

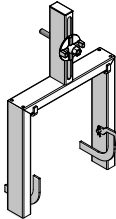

Ref.-No.	Description / Application	m ²	kg
29-416-82	Ladder fixture, upper wall formwork - top	7.90	

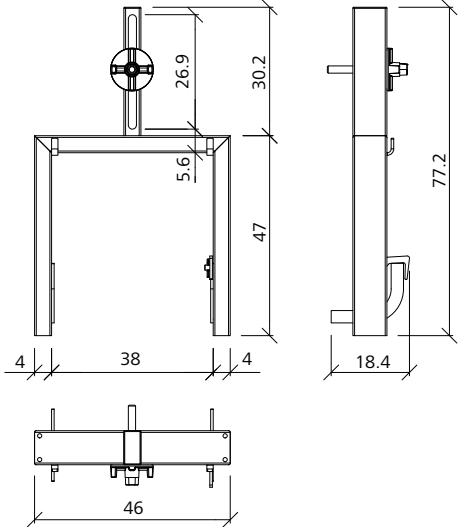

Ladder fixture, lower wall formwork

Galvanized. Attached to the multi-function profile at the bottom of the horizontal or vertical panel to hold the ladder or extension ladder.

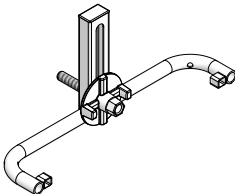

Ref.-No.	Description / Application	m ²	kg
29-416-84	Ladder fixture, lower wall formwork - bottom	2.40	

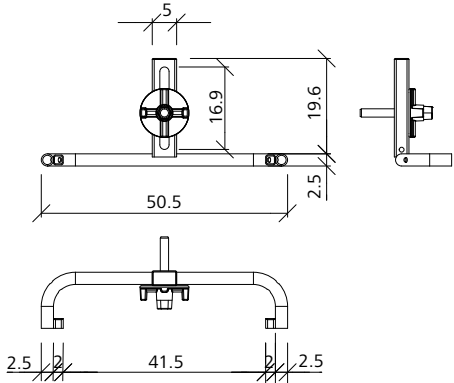

Folding access platform
BKB 125

Self-locking; ready-made platform with a foldable guardrailing and an overall width of 125 cm; it is suspended onto the frame profile of the panels. The 48 mm thick planking is protected at the front ends. Stacking height 17cm; load capacity 2 kN/m².

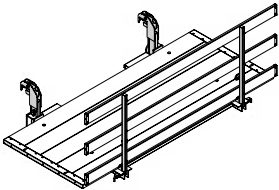

Ref.-No.	Description / Application	m ²	kg
29-417-10	Folding access platform BKB 125/235	196.00	
29-417-20	Folding access platform BKB 125/300	216.00	
29-417-00	Folding access platform BKB 125/140	114.00	
29-417-30	Side railing BKB 125	16.30	

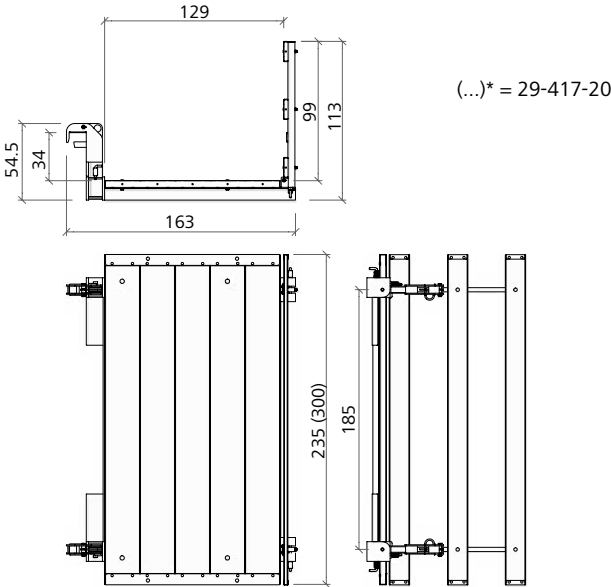

Folding access platform BKB 125/140

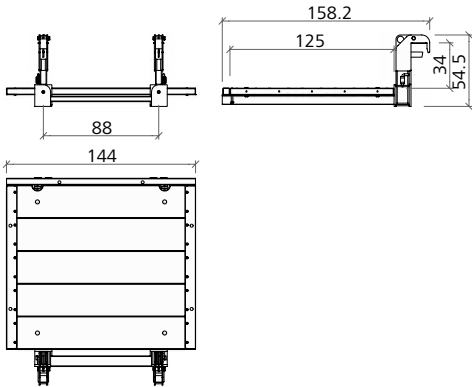
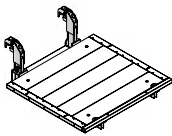

Side railing BKB 125

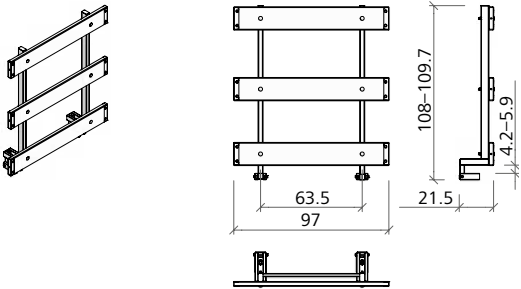

Notes

A large grid of small dots for taking notes.

Notes

A large grid of small dots for taking notes, consisting of 20 columns and 30 rows.



MEVA Schalungs-Systeme GmbH

Industriestrasse 5
72221 Haiterbach
Germany

Tel. +49 7456 692-01
Fax +49 7456 692-66
info@meva.net
www.meva.net