

Product list

Please note

This product list includes all parts necessary for most applications.
For parts required for special applications, please refer to the MEVA price list. Dimensions are in centimetres (cm) unless a different unit is shown.

Contents

AluFix prop head evo	30
AluFix AL panels	24
EA assembly lock	27
EuMax Pro 20	29
EuMax Pro 30	28
Forked prop head	31
Formwork girder H20	32
MEP prop with SAS	30
MEVA alu-beam 20/245	33
Pin	32
Plug D20	27
Railing clamp	33
Tripod	31

Slab formwork

AluFix AL panels

Construction height 10 cm, frame profile width 23 mm. The frames of the AluFix panels are made of closed 3-chamber aluminium profiles and are torsion-proof. They are easy to clean thanks to their high-quality annealed powder coating. The AluFix AL panels are equipped with alkus facing. All-around grooves and EA assembly locks guarantee a tight and perfectly aligned panel connection.

Panel height 2.70 m

7 cross stiffeners, of which 3 are multi-function profiles with welded DW-threaded nuts.
3 tie holes per panel height.

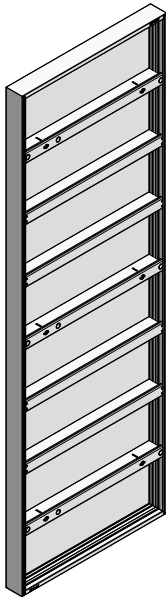

Ref.-No.	Description / Application	m ²	kg
22-137-10	AluFix AL.....270/90	2.43	47.80
22-137-25	AluFix AL.....270/75	2.03	41.30
22-137-45	AluFix AL.....270/55	1.49	31.60
22-137-60	AluFix AL.....270/40	1.08	24.90
22-137-75	AluFix AL.....270/25	0.68	18.50

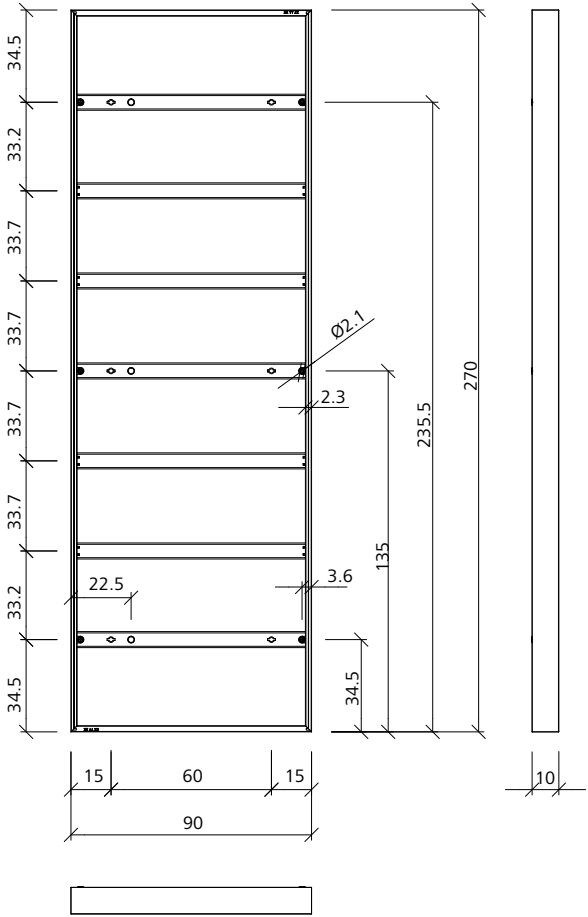

Attention
Unused tie holes need to be closed with plugs D 20.

Slab formwork

Panel height 2.50 m

7 cross stiffeners, of which 3 are multi-function profiles with welded DW-threaded nuts. 3 tie holes per panel height.

Attention

Unused tie holes need to be closed with plugs D 20.

Ref.-No.	Description / Application	m ²	kg
22-138-10.....	AluFix AL.....250/90.....	2.25	45.20
22-138-25.....	AluFix AL.....250/75.....	1.88	38.10
22-138-45.....	AluFix AL.....250/55.....	1.38	29.80
22-138-60.....	AluFix AL.....250/40.....	1.00	23.50
22-138-75.....	AluFix AL.....250/25.....	0.63	17.40

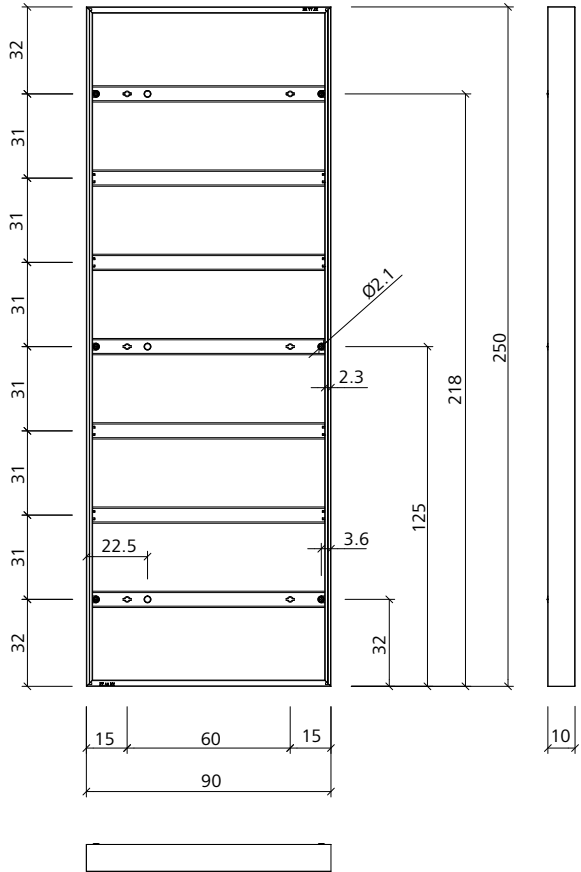
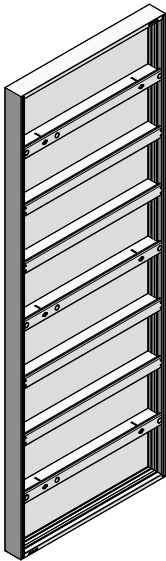

Slab formwork

Panel height 1.50 m

3 cross stiffeners, of which 2 are multi-function profiles with welded DW-threaded nuts. 2 tie holes per panel height.

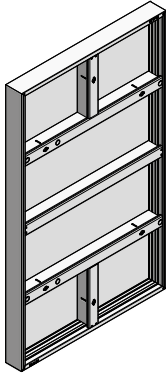

Ref.-No.	Description / Application	m ²	kg
22-135-10.....	AluFix AL..... 150/90.....	1.35	27.70
22-135-25.....	AluFix AL..... 150/75.....	1.13	23.60
22-135-45.....	AluFix AL..... 150/55.....	0.85	18.80
22-135-60.....	AluFix AL..... 150/40.....	0.60	15.10
22-135-75.....	AluFix AL..... 150/25.....	0.38	10.30

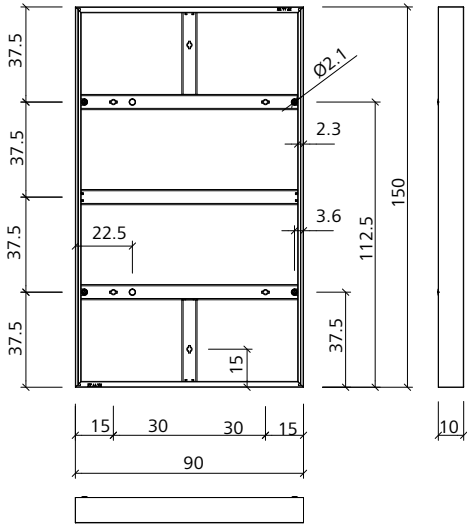

Panel height 1.35 m

3 cross stiffeners, of which 2 are multi-function profiles with welded DW-threaded nuts. 2 tie holes per panel height.

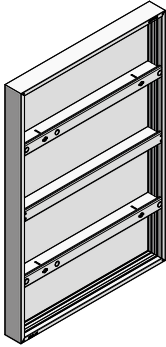

Ref.-No.	Description / Application	m ²	kg
22-139-10.....	AluFix AL..... 135/90.....	1.22	24.10
22-139-25.....	AluFix AL..... 135/75.....	1.01	20.70
22-139-45.....	AluFix AL..... 135/55.....	0.74	16.30
22-139-60.....	AluFix AL..... 135/40.....	0.54	12.80
22-139-75.....	AluFix AL..... 135/25.....	0.34	9.50

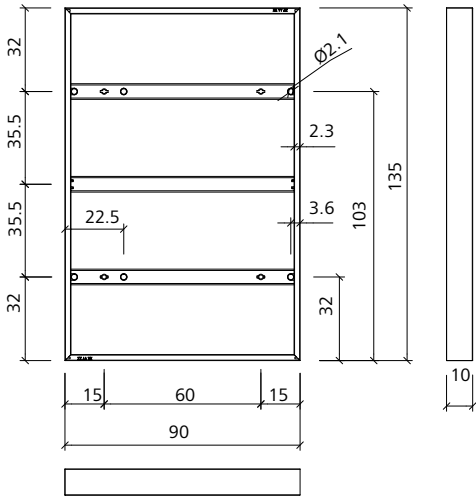

Attention
Unused tie holes need to be closed with plugs D 20.

Slab formwork

EA assembly lock

Galvanized. Tightly connects and aligns AluFix and EcoAs panels. Clamping length 4.6 cm.

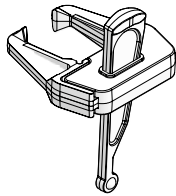

Ref.-No.	Description / Application	m ²	kg
29-205-50	EA-assembly lock		1.50

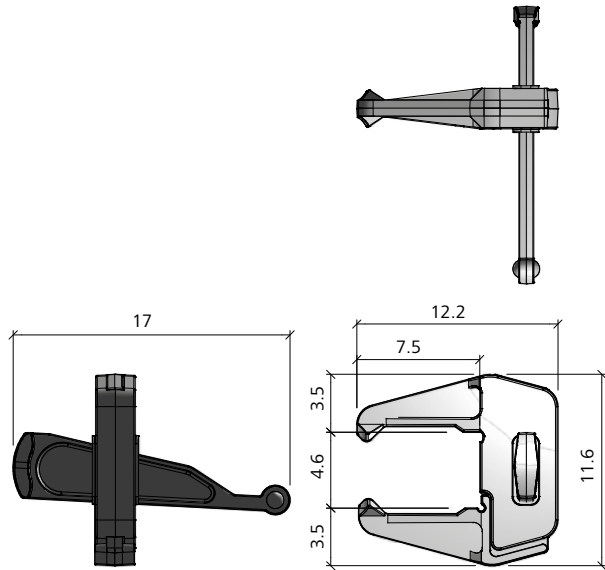

Plug D20

Is used to close unused tie holes (AluFix, EcoAs, AluStar and StarTec).



Ref.-No.	Description / Application	m ²	kg
29-902-63	Plug D20		

Slab formwork

EuMax Pro 30

Galvanized. Prop in accordance with EN 1065, class E. Permissible load capacity at all extension lengths is 30 kN.

Ref.-No.	Description / Application	m ²	kg
X22-0073	EuMax Pro 30/150(98-150)		11.50
X22-0074	EuMax Pro 30/250(152-250)		18.50
X22-0075	EuMax Pro 30/350(202-350)		23.40
X22-0076	EuMax Pro 30/450(252-450)		33.00

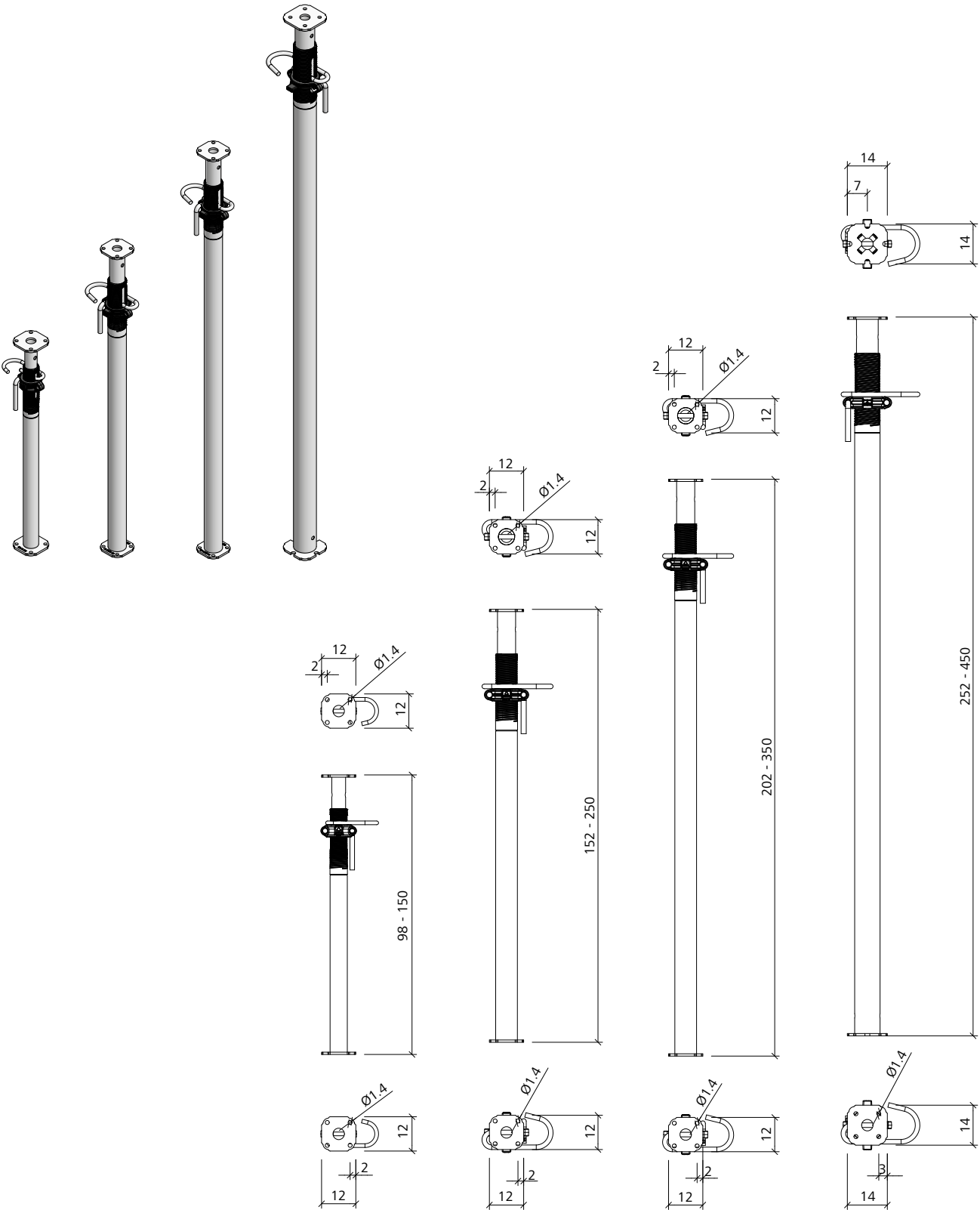

Slab formwork

EuMax Pro 20

Galvanized. Prop in accordance with EN 1065, class D. Permissible load capacity at all extension lengths is 20 kN.

Ref.-No.	Description / Application	m ²	kg
X22-0070	EuMax Pro 20/300(177-300).....		18.30
X22-0071	EuMax Pro 20/400(232-400).....		24.70
X22-0072	EuMax Pro 20/550(302-550).....		38.00

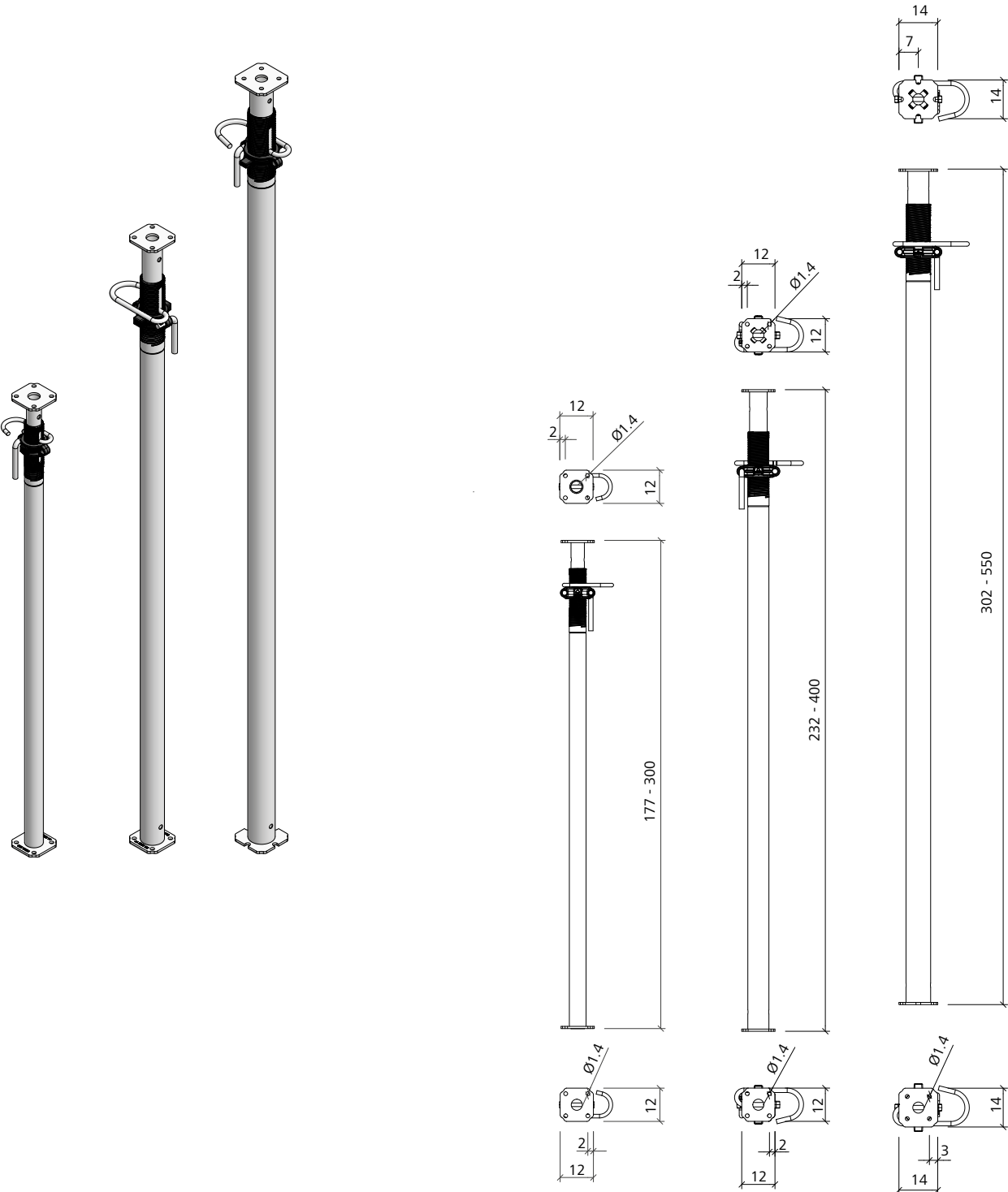

Slab formwork

MEP prop with SAS

The MEP prop has a steel inner tube and an aluminium outer tube with a T-groove to attach reinforcing frames. The SAS quick-lowering system allows the stress in the prop to be released with one strike of a hammer. After stripping the prop automatically resets and locks in the original position. According to European standard EN 1065 class E, the MEP 300 props with SAS have a load capacity of 40 kN at all extensions. The MEP 450 props with SAS have a load capacity of 20 kN; if assembled with the inner tube downwards, the load capacity increases to 30 kN.

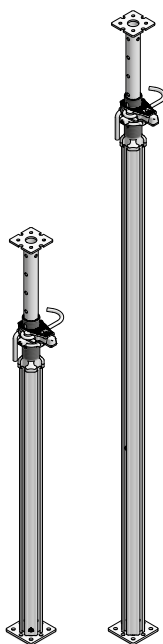

Ref.-No.	Description / Application	m ²	kg
29-907-65	MEP-prop 300 with SAS ... (185-300)		26.70
29-907-70	MEP-prop 450 with SAS (300-450)		34.30

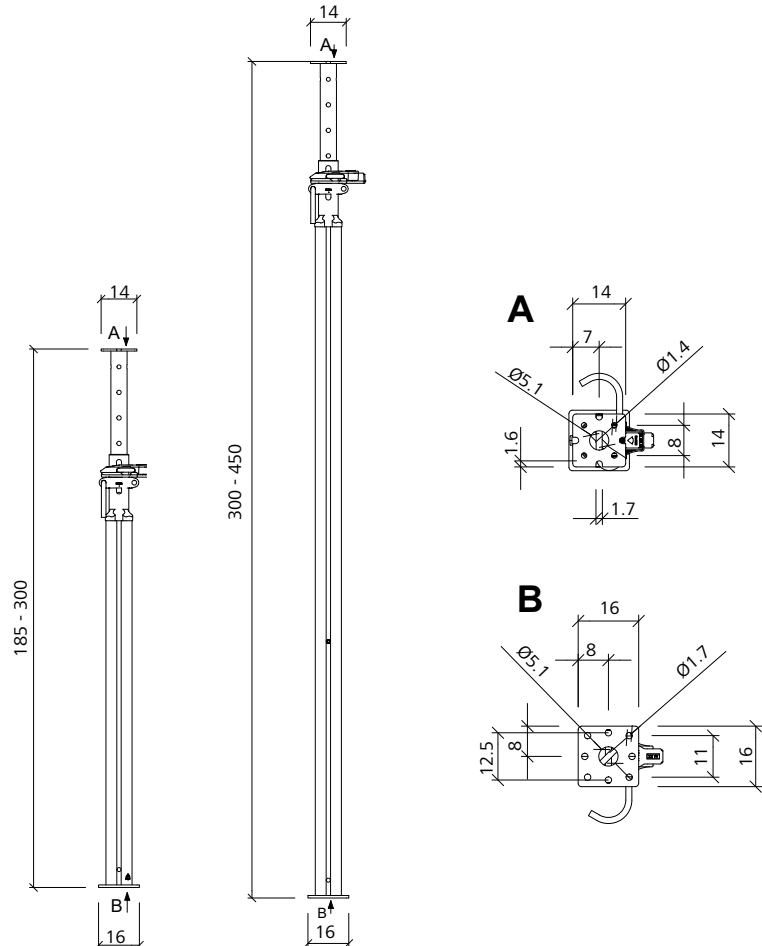

AluFix prop head evo

Made of steel, hot-dip galvanized. This type of prop head with wedge permits quick lowering of the formwork panels. It supports AluFix panels used in slab formwork. It is inserted into the head or foot plate of the prop and secured with a pin 14/90e (pin 14/135 if fixed to the outer tube of MEP props).

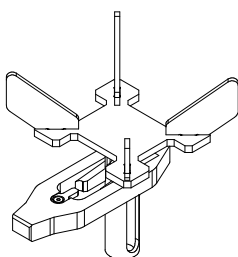

Ref.-No.	Description / Application	m ²	kg
29-202-80	AluFix prop head evo		1.53

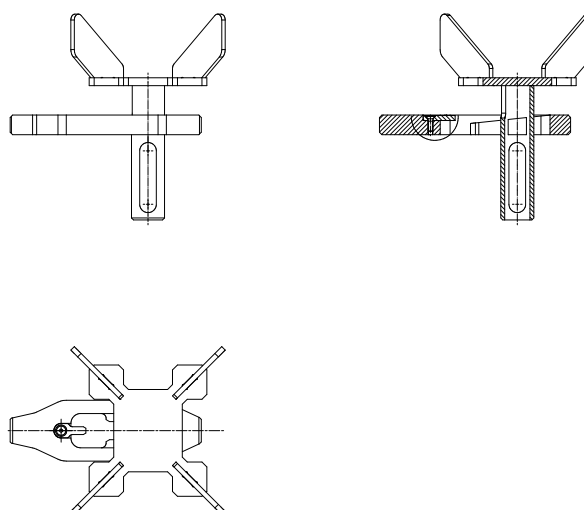

Slab formwork

Tripod

Galvanized auxiliary to stabilize props with Ø 48 to 80 mm. The turnable legs allow the tripod to be used in rooms, along walls or in corners. The tripod can be attached to the aluminium profile of the MEP props with the MD safety claw.

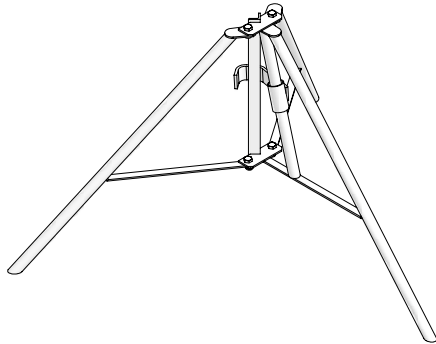

Ref.-No.	Description / Application	m ²	kg
29-905-50 Tripod	8.00	
29-905-52 Tripod 120	17.70	

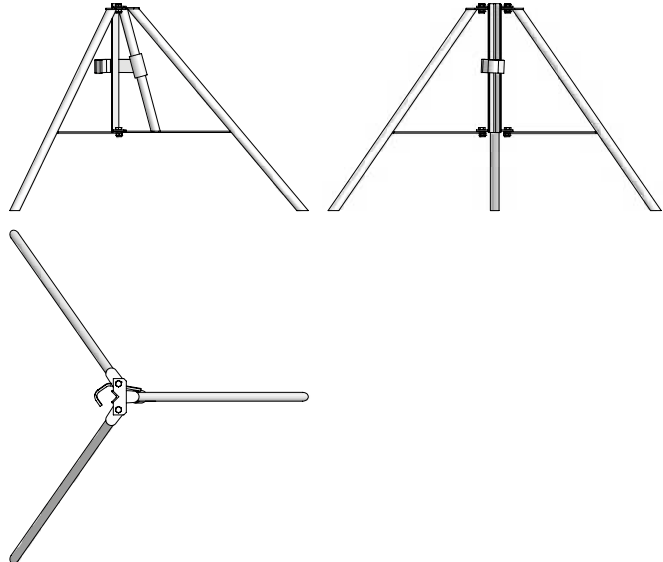

Forked prop head

Galvanized. Supports wooden formwork girders. Is attached to EuMax props with pin 14/90e or to MEP props with pin 14/135. The forked prop head 20 is used with H20 formwork girders

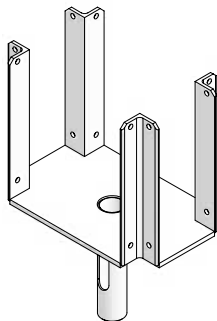

Ref.-No.	Description / Application	m ²	kg
29-206-40 Forked prop head H20	3.00	

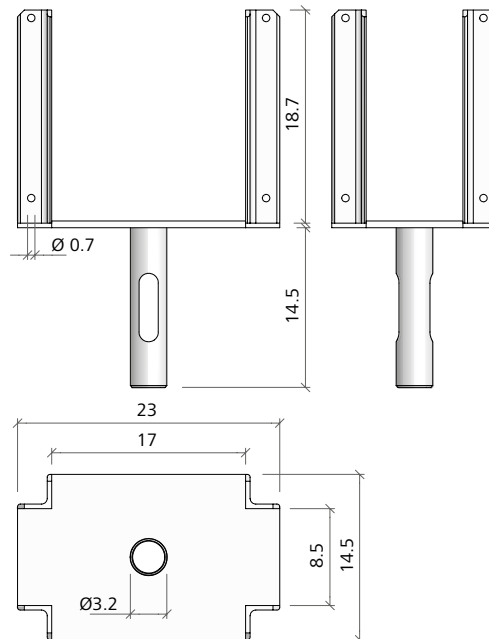

Slab formwork

Pin

Galvanized. Used to secure the MevaDec drop head, the forked prop heads, etc. on the corresponding props. Pin 14/90e is used for steel tube props up to Ø63 mm. Pin 14/135 is used with the aluminium profile of MEP props and MEP extensions.

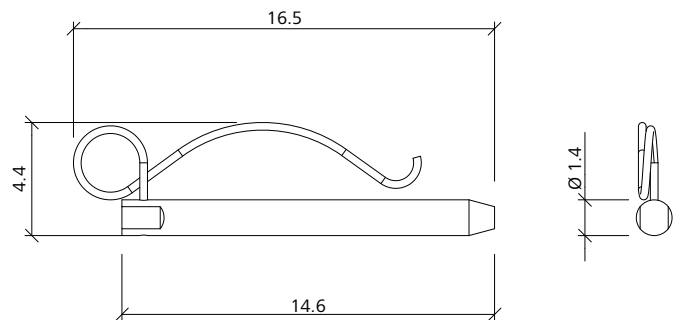
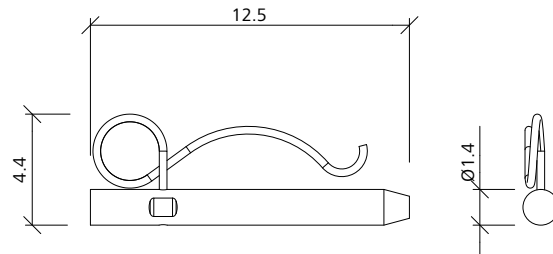
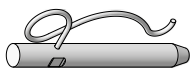

Formwork girder H20

Robust multi-purpose girder for the most different tasks. While the girder itself does not weigh much, it has a high load-bearing capacity (approved by building authorities). Admissible load: Q = 11 kN, M = 5 kNm.

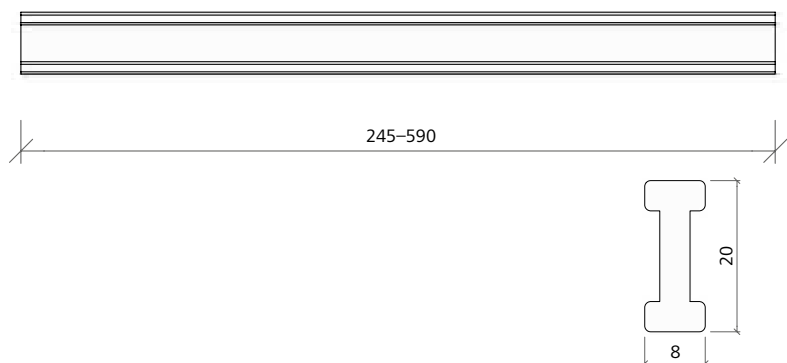
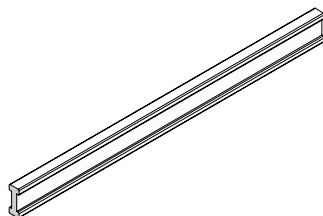

Ref.-No.	Description / Application	m ²	kg
29-909-90 Pin 14/135	0.18
29-803-55 Pin 14/90e	0.15

Ref.-No.	Description / Application	m ²	kg
29-206-02 Formwork girder H20/245	12.30
29-206-05 Formwork girder H20/290	14.50
29-206-10 Formwork girder H20/330	16.50
29-206-20 Formwork girder H20/390	19.50
29-206-30 Formwork girder H20/450	22.50
29-206-45 Formwork girder H20/490	24.50
29-206-48 Formwork girder H20/590	29.50

Slab formwork

MEVA alu-beam 20/245

Robust aluminium girder with integrated plastic bar. Usable for different applications. High load capacity thanks to stable form. Load: Q (cross force) = 39.73 kN, adm. M = 25.96 kN

Ref.-No.	Description / Application	m ²	kg
29-216-15	MEVA alu-beam 20/245		26.20
29-216-45	MEVA alu-beam 20/390		42.00

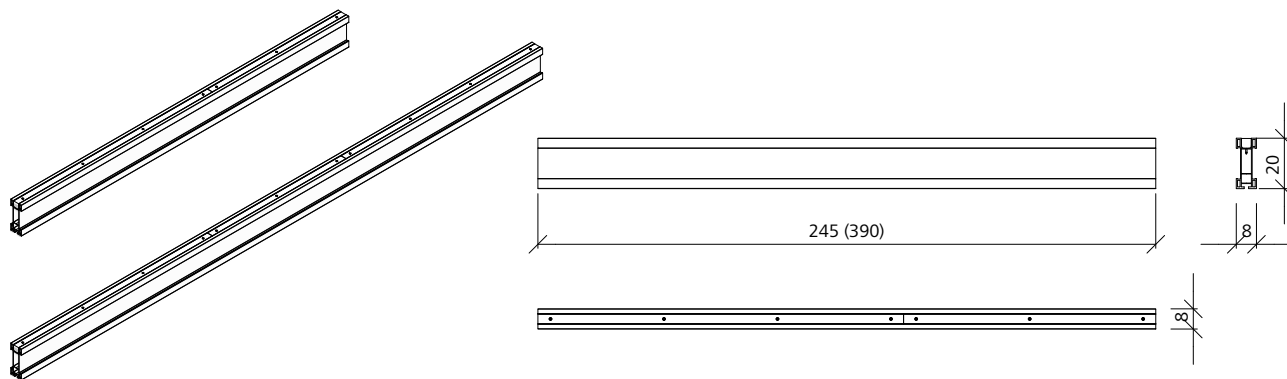

Railing clamp

Coated. Can be clamped to all types of beams and to free slab edges. Railing clamp 100: 100 cm high, clamping length 45 cm. Railing clamp 140: 140 cm high, clamping length 50 cm.

Ref.-No.	Description / Application	m ²	kg
29-107-20	Railing clamp 100		7.90
29-107-25	Railing clamp 140		10.10

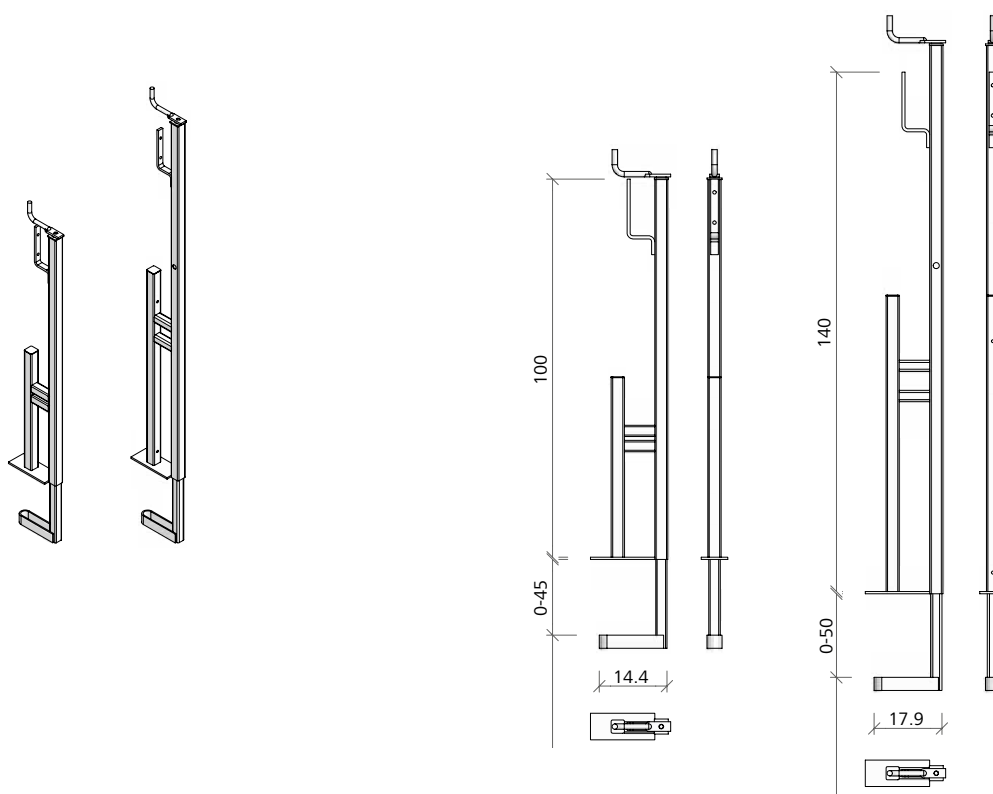

Notes

A large grid of small dots for taking notes, consisting of 20 columns and 30 rows.

Notes

A large grid of small dots for taking notes, consisting of approximately 30 columns and 40 rows.



MEVA Schalungs-Systeme GmbH

Industriestrasse 5 Tel. +49 7456 692-01
72221 Haiterbach Fax +49 7456 692-66
Germany info@meva.net

www.meva.net